



CAUTION

Turn off the main power at the circuit breaker before installing the fixture in order to prevent possible shock. If you are unfamiliar with proper electrical wiring connections, obtain the services of a qualified electrician.

GENERAL

Read all instructions carefully for safe operation and installation. All electrical connections must be in accordance with local and national electrical code (N.E.C.) standards.

Remove the fixture and mounting package from the box. Make sure no parts are missing by referencing these Installation Instructions. Please contact Blackjack Lighting at 847-941-0588 if any parts are missing or damaged, or for replacement battery packs.

Fixture parts included:

One rear housing with integrated LED light source and one acrylic diffuser; One aluminum junction box mounting bracket.

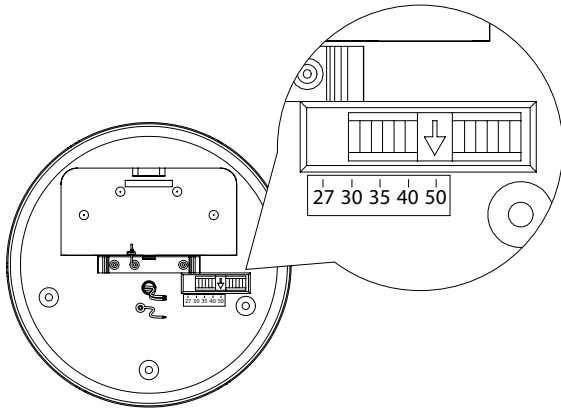

1. Select Color Temperature.

Select the proper CCT color temperature by adjusting the CCT switch on the the rear housing.

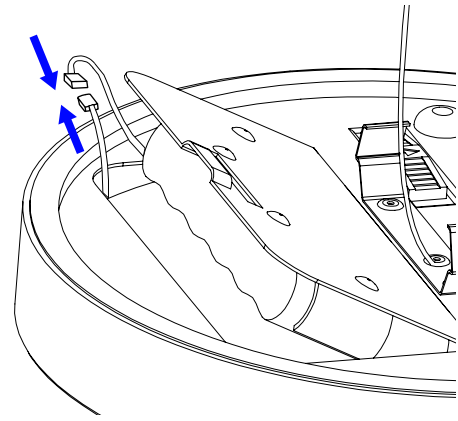

2. Connect battery pack.

Snap connectors together to connect the battery pack to the fixture.

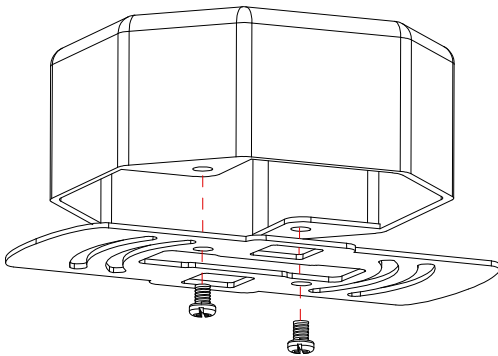

3. Attach mounting bracket.

Attach aluminum mounting bracket onto junction box with two (2) screws provided.

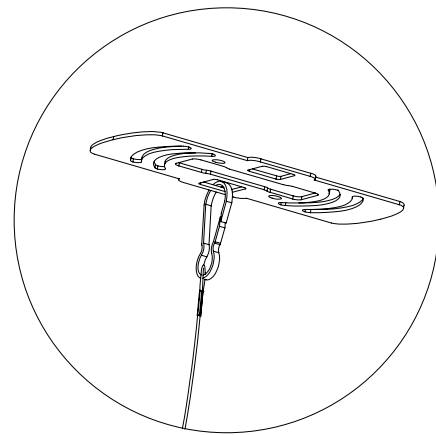

4. Connect safety wire.

Attach steel safety wire to mounting bracket using clasp.

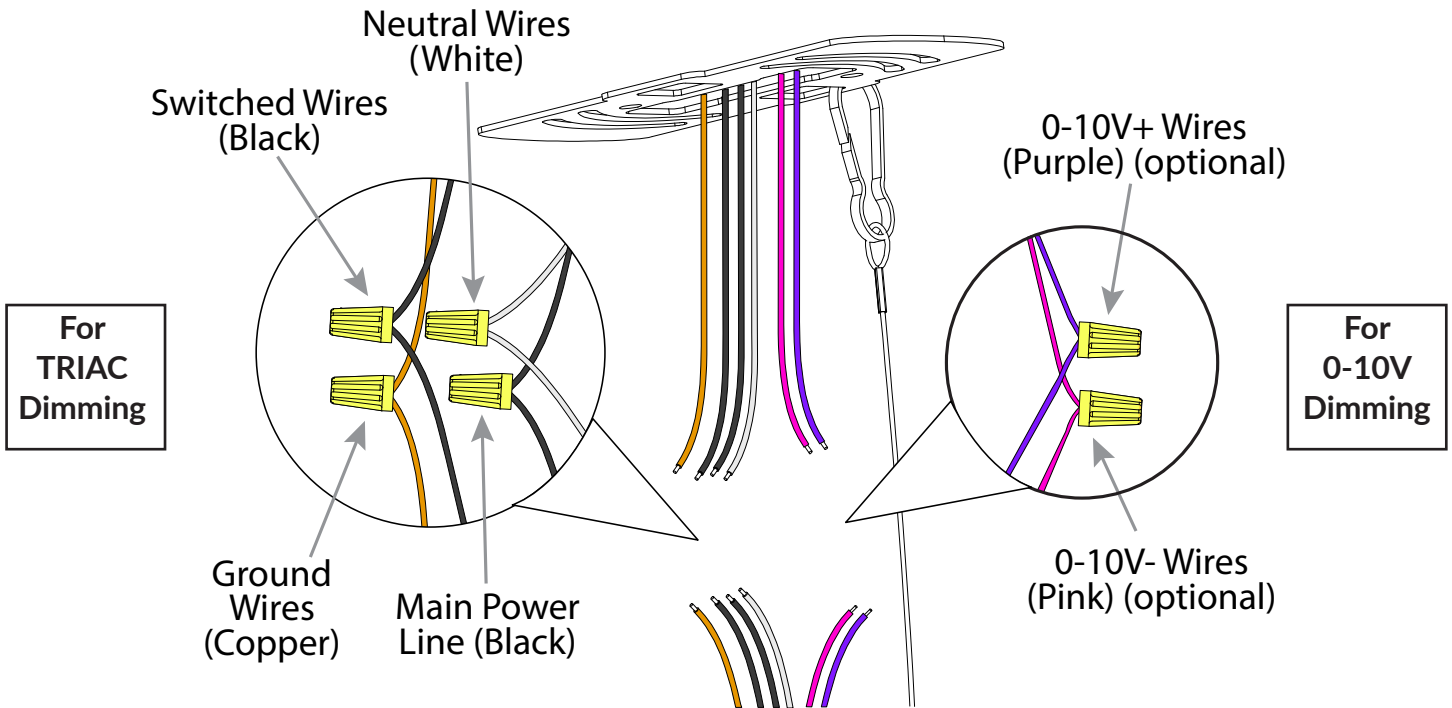

5. Make wire connections.

For TRIAC Dimming: Connect black to black, white to white, ground to ground, *then cap off the purple and pink wires separately.*

For 0-10V Dimming: Connect black to black, white to white, ground to ground, purple to purple, and pink to pink.

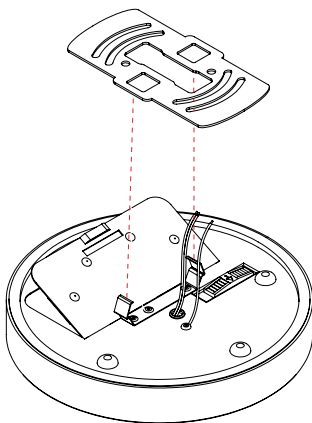

6. Attach fixture to bracket.

Align spring side with two square bracket holes and push in fixture body until fixture snaps securely into place.

CALLOUTS

