

CAUTION

Turn off the main power at the circuit breaker before installing the fixture in order to prevent possible shock. If you are unfamiliar with proper electrical wiring connections, obtain the services of a qualified electrician.

GENERAL

Read all instructions carefully for safe operation and installation.

All electrical connections must be in accordance with local and national electrical code (N.E.C.) standards.

Remove the fixture and mounting package from the box. Make sure no parts are missing by referencing these Installation Instructions.

Please contact Blackjack Lighting at 847-941-0588 if any parts are missing or damaged. This product is suitable for DAMP locations.

PARTS AND ACCESSORIES

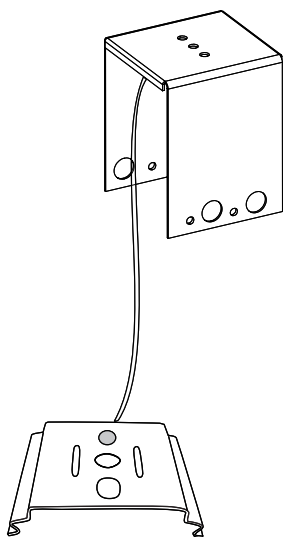

U-Bracket with Safety Wire and Safety Clip (2); (3) for 8-Ft. Fixture



M3 Phillips Screws (8)

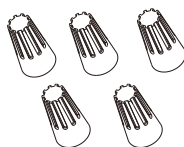

Twist-On Wire Connectors (5)

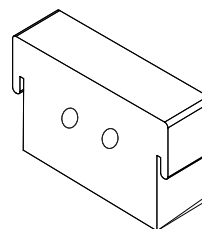

Recessed Mounting Spacers (3)

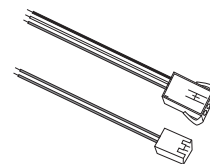

AC Input Cables (1 set of 2)

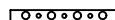

Short Channel L-Bracket (2)



Channel L-Bracket (2)

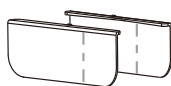

Left & Right Shielding Plates (Included only with runs of multiple pendants)

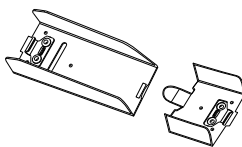

Internal Connector (Included only with runs of multiple pendants)

Shielding plates and connector only provided for multiple pendant runs.



Module Cover Removal Tool (1)
(Used to remove upper module cover).

INSTALLATION for RECESSED MOUNTING
CEILING CUTOUT GUIDE

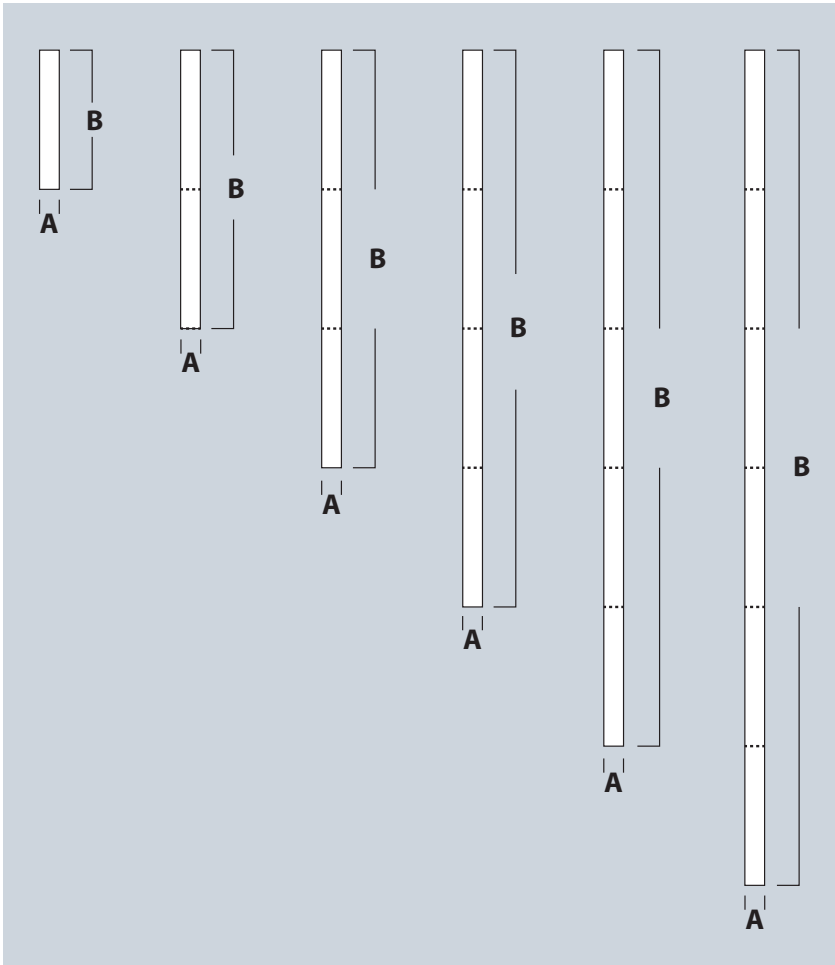

Quantity	A (Width)	B (Length)
1 x 24"	2.5"	24.38
1 x 48"	2.5"	48"
2 x 48"	2.5"	95.25"
3 x 48"	2.5"	142.50"
4 x 48"	2.5"	189.75"
5 x 48"	2.5"	237"
6 x 48"	2.5"	284.25"
1 x 96"	2.5"	95.25"
2 x 96"	2.5"	189.75"
3 x 96"	2.5"	284.25"

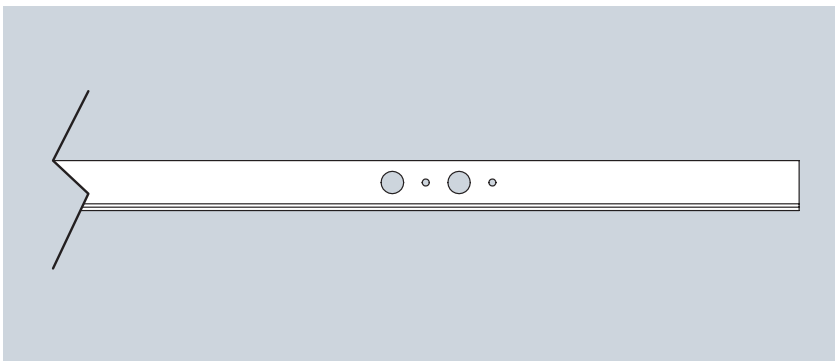

PLEASE NOTE: For recessed installations greater than 48" in length, one set of "L" channels will be cut shorter than the other "L" channels.

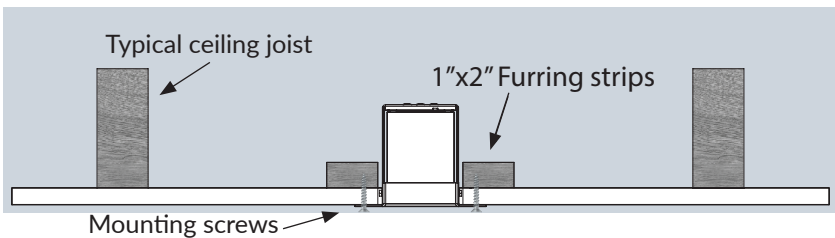

1" x 2" wood furring strips (or similar, not provided) to be placed on both sides of the hole cut into the sheet rock. Glue strips in place or clamp in place while installing mounting screws.

INSTALLATION for RECESSED MOUNTING *(continued)*

1

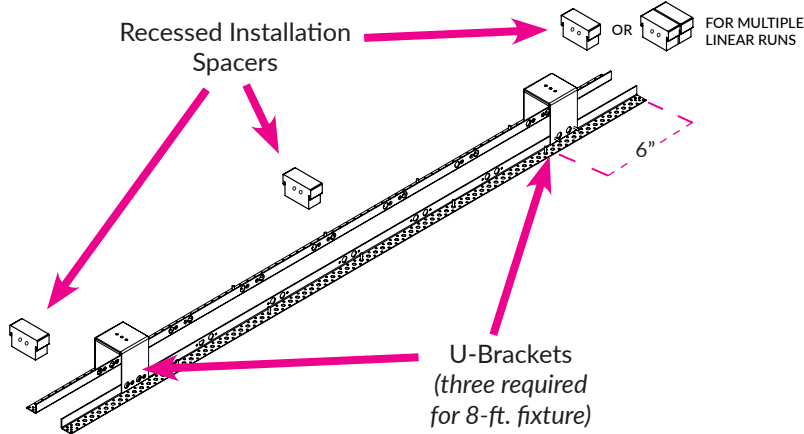

Step 1A. Place Channel L-Brackets on table or floor. Place Recessed U-Brackets over the matching holes on the two Channel L-Brackets; attach each bracket with two M3 screws, approx. 6" from each end.

Step 1B. Place recessed installation spacer into the "L" channel brackets in three locations, centered and on both ends. Spacers help with alignment. Keep spacers attached until brackets are mounted to the opening with fasteners.

2

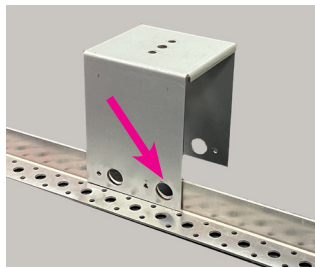

PROPER HOLE ALIGNMENT

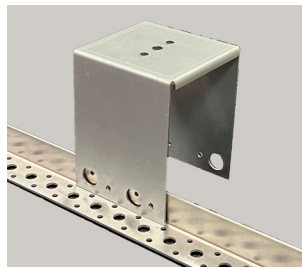

IMPROPER HOLE ALIGNMENT

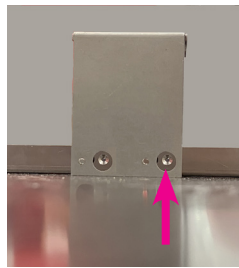

ACCESS SCREW THROUGH LARGE HOLE

Step 2. Set up brackets near each end of the run. Keep in mind the orientation of the bracket, as it will only be able to be screwed in one way. Holes should align to where a screwdriver will fit through the large hole, allowing access to tighten the screws in the smaller hole. No nuts are needed. The structure should be rigid when complete.

3

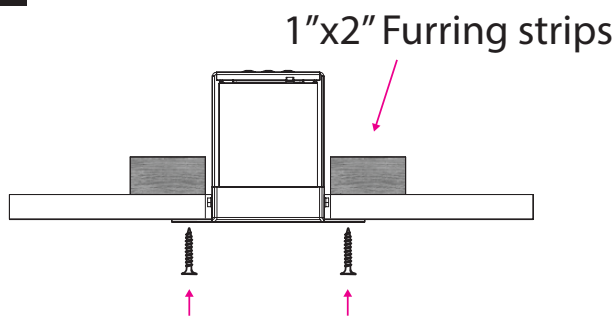

Step 3. Cut an opening in ceiling/sheet rock surface. Push support bracket structure up into the opening cut into the ceiling. Part of the L-Bracket will remain outside of hole on face of ceiling. Secure by screwing Phillips #6 flathead sheet rock screws (not provided) through larger holes into wooden furring strips through the ceiling material. You will use approximately one screw every 8", starting approximately 8" from each end.

4

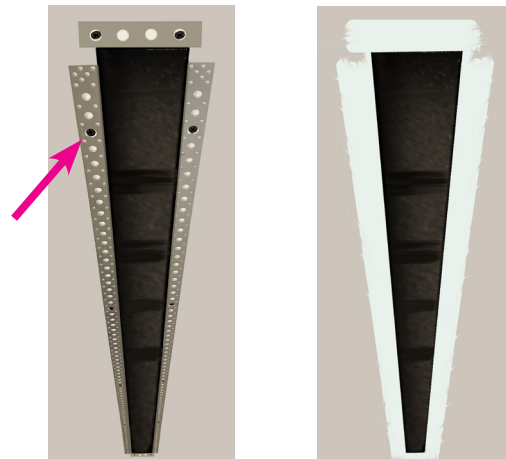

Step 4A. Remove installation spacers from channel (lift, rotate, remove). Keep and re-use spacers if installing multiple linear fixtures.

Step 4B. Apply finished plaster layer over exposed metal frame and screws. Sand and paint until smooth.

INSTALLATION for RECESSED MOUNTING *(continued)*

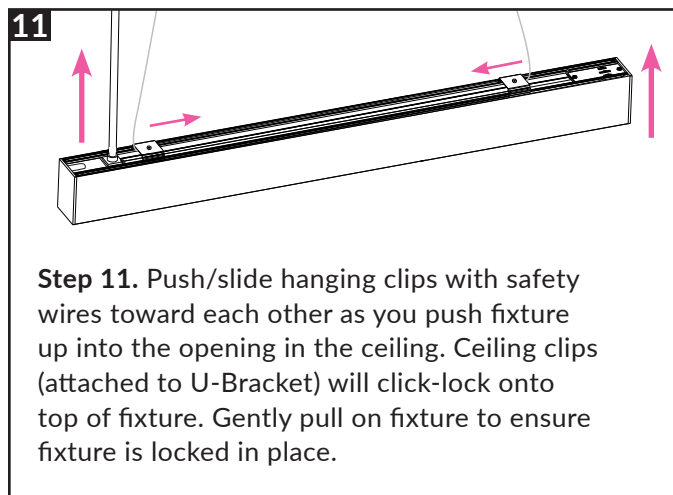
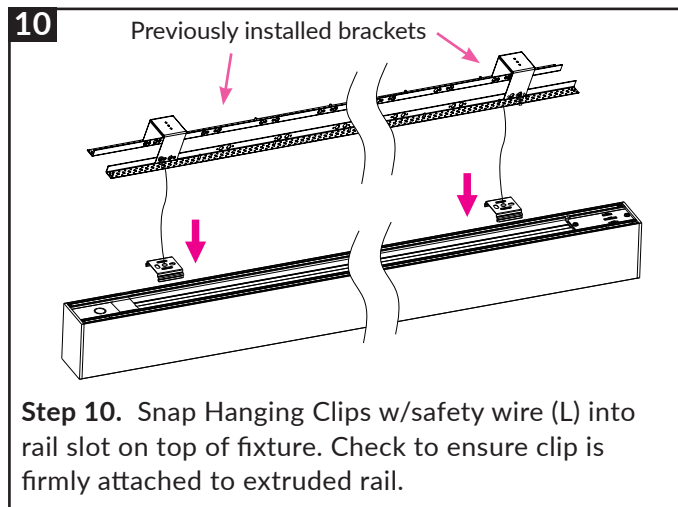
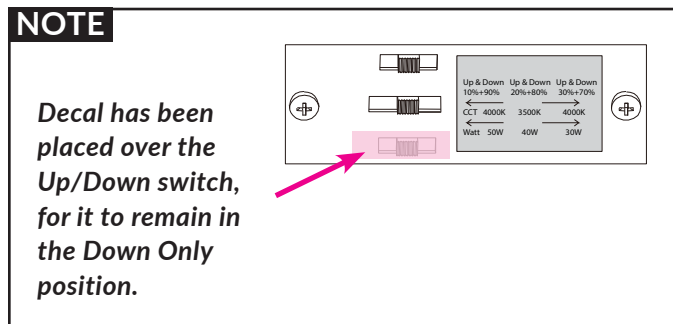
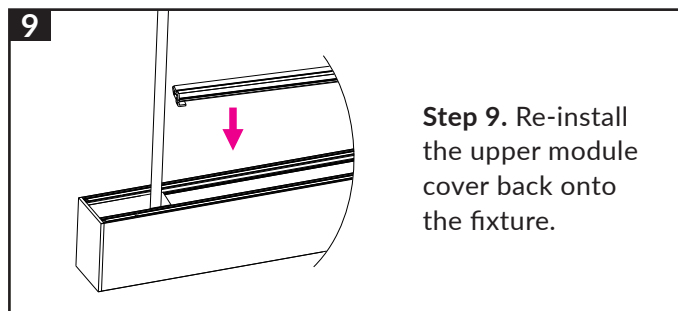
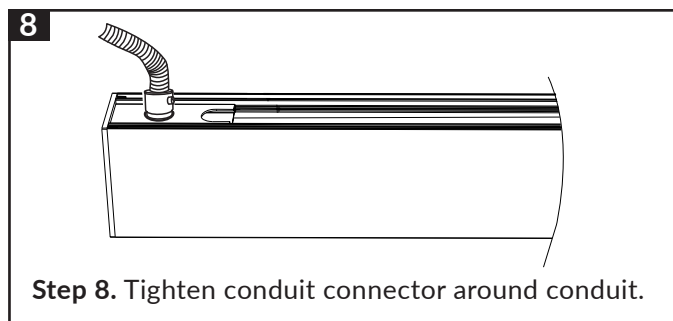
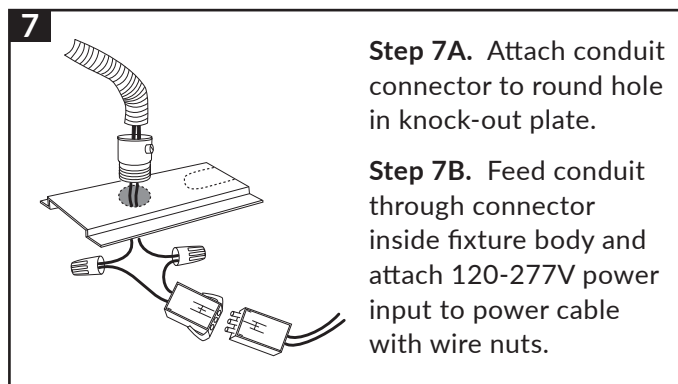
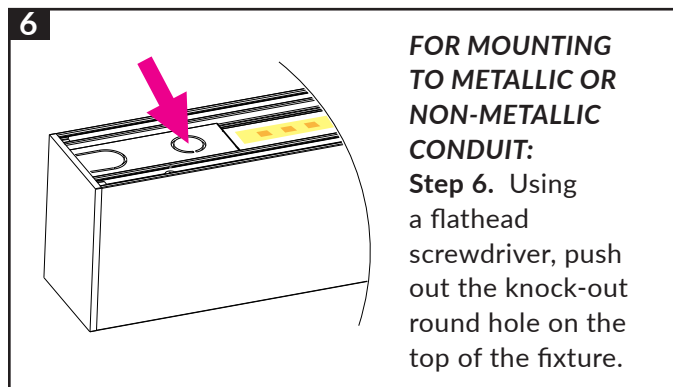
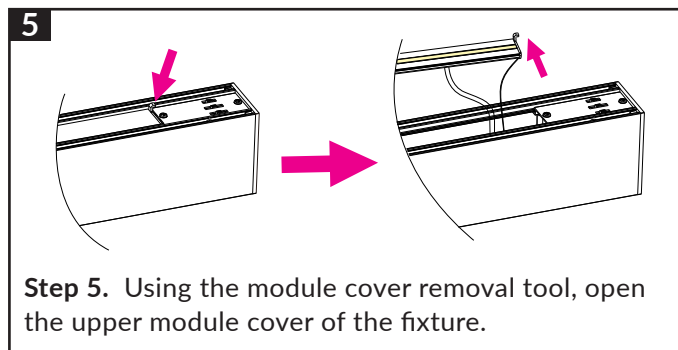

INSTALLATION of MULTIPLE PENDANTS

NOTE

If linear 1 is already mounted to the ceiling, pull the fixture straight down to detach it from the mounting clips. Allow the fixture to hang from the safety wires. Then, at the arm/latch, use flathead screwdriver to remove the top module cover.

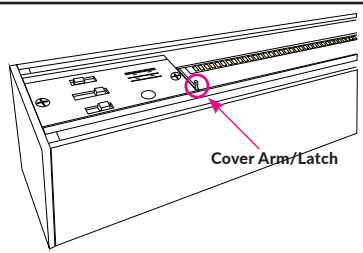

1

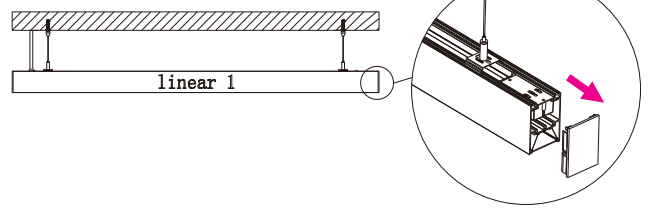

Step 1. Remove one end cap from switch end of the first powered fixture (linear 1).

2

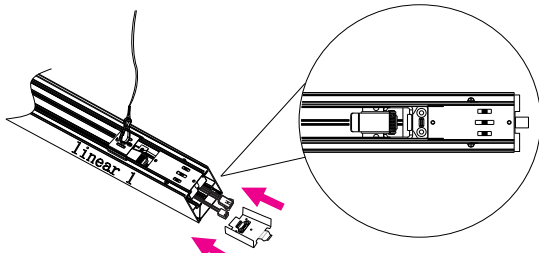

Step 2. Slide hanging clip away from end of fixture. Pull out interconnecting cables. Insert internal connector into the fixture body, and use snap spring to fasten the hook.

2A

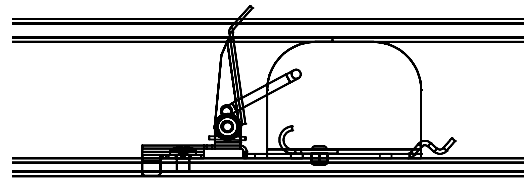

Pull back lever on internal spring latch.

2B

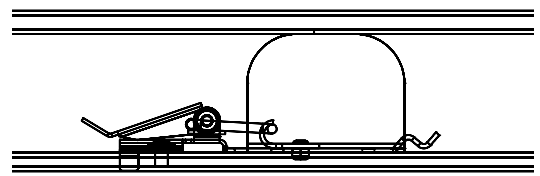

Secure joiner on internal spring latch.

3

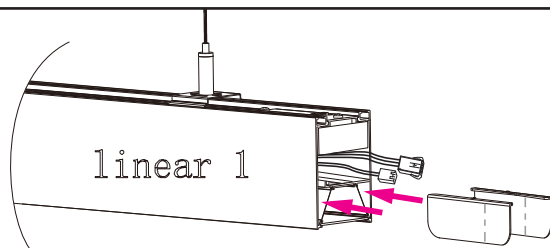

Step 3. Insert the left and right shielding plates into the linear 2 fixture body, respectively. Leave short portion extending out of extrusion.

4

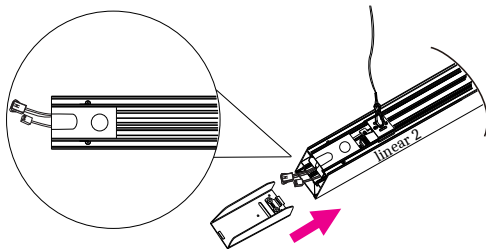

Step 4. Slide hanging clip away from end of fixture. Insert internal connector into the fixture body, and use snap spring to fasten the hook (See Steps 2A & 2B, above).

4A

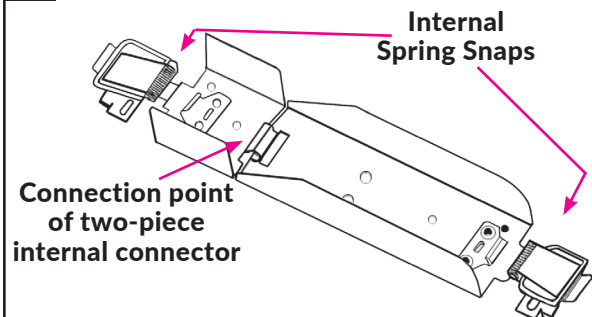

Step 4A. Close-up of internal linear connectors, as it will be inside of housing. The two-piece hinged internal connector is connected together, and each connected to the snap springs.

INSTALLATION of MULTIPLE PENDANTS (continued)

