

PROJECT:		SPECIFIER:	
SKU:			
QUANTITY:		DATE:	

Features

- Small, low profile canopy
- May be used with any Blackjack multi-port pendant
- Designed for use in multiples with remote mounted driver
- Mounts to ceiling with two screws (not included)
- Does not include cable assembly or pendants (must be purchased separately)
- Available in Black, White, or Polished Chrome

Specifications

- 92087 - WH (Matte White)
- 92087 - BL (Matte Black)
- 92087 - PC (Polished Chrome)

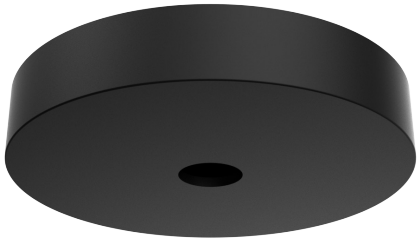
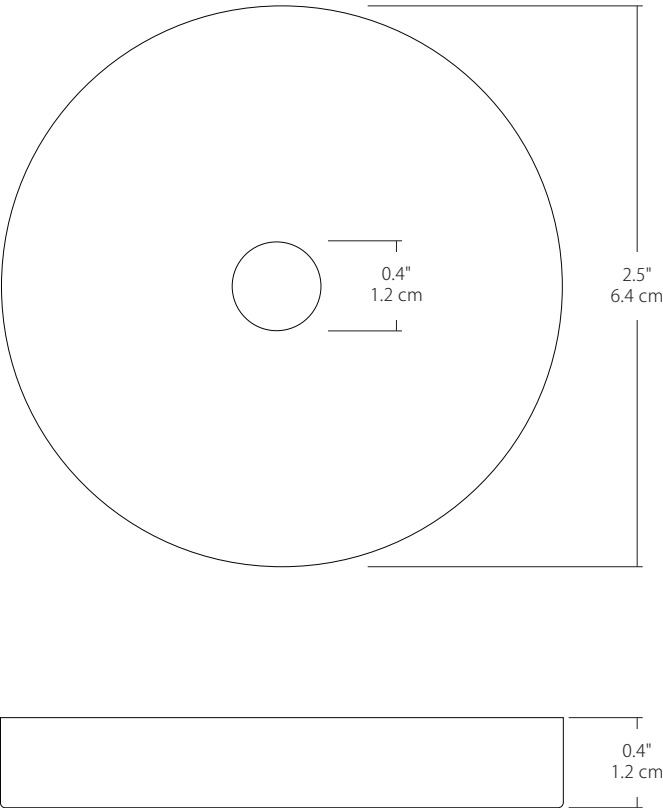

92087-BL

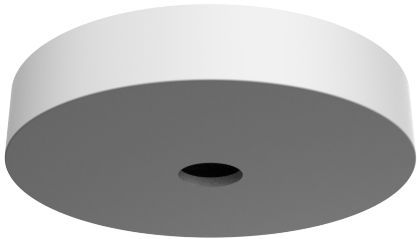

92087-WH

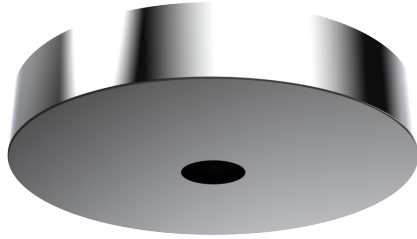

92087-PC

ORDERING GUIDE

PART NO.

92087

FINISH
COLOR



BL - Matte Black
WH - White
PC - Polished Chrome

Example: 92087-WH

	CAUTION	
	TURN OFF THE MAIN POWER AT THE CIRCUIT BREAKER BEFORE INSTALLING THE FIXTURE IN ORDER TO PREVENT POSSIBLE SHOCK	IF YOU ARE UNFAMILIAR WITH PROPER ELECTRICAL WIRING CONNECTIONS, OBTAIN THE SERVICES OF A QUALIFIED ELECTRICIAN

GENERAL

- Read all instructions carefully for safe operation and installation.
- All electrical connections must be in accordance with local and national electrical code (N.E.C) standards.
- Remove the fixture and the mounting package from the box and make sure that no parts are missing by referencing the illustrations on the installation instruction. Please contact Blackjack if any parts are missing or damaged.
- This product is suitable for damp locations.

INSTALLATION

Preparation

1. Take the fixture out of box. Unpack bundled wire packages, but be careful not to bend or kink wires when unpacking. Remove additional package with additional pendants (sold separately).
2. Remove the mounting plate (5) from the canopy cover (2) by unscrewing canopy cover from mounting plate (5).
3. Drill two support holes using the appropriately sized drill bit. Insert the provided ceiling anchors (7) into the holes. Screw the anchor screws (6) into the ceiling anchors until fully tightened.

Mounting

4. Install the gripper (10) in the mounting hole in the canopy cover. Pull the coaxial cable through the gripper to determine the desired height of pendant (1).
5. Insert the power disconnect (8) through the center hole in the mounting plate (5) and the ceiling. Once the wire (3) is through the hole, screw the canopy cover (2) to the mounting plate (5).

Connecting Wires

6. Make the wiring connections: connect the white power disconnect (8) to the wire harness (9); (note: the total length of coaxial cable is 96", so pendant drop length in addition to the distance from the fascia canopy to the wire harness must be less than 96"). Then, attach line voltage (and dimming if required) to the input side of the driver (4).

Final Assembly

7. Once the canopy is in place, fine tune the wire lengths longer or shorter to its preferred length by adjusting the gripper.
8. Once the length of each wire has been established, any remaining bends or kinks in the wire can be straightened by bending out the kinks by hand while heating the cord up with the warm air from a hair dryer or heat gun.

DIMMING

- Fixture Dimming Type: 0 – 10V, TRIAC, and ELV
- For recommended dimmers, see blackjacklighting.com

HARDWARE

Mounting Screws (#6)
(Not Included)

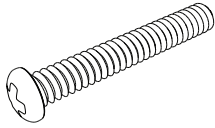

Sheet Rock Anchors (#7)
(Not Included)

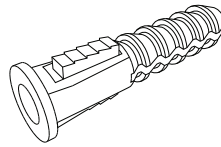

Hex Nut (#10)
1 Included



GENERAL WIRING DIAGRAM

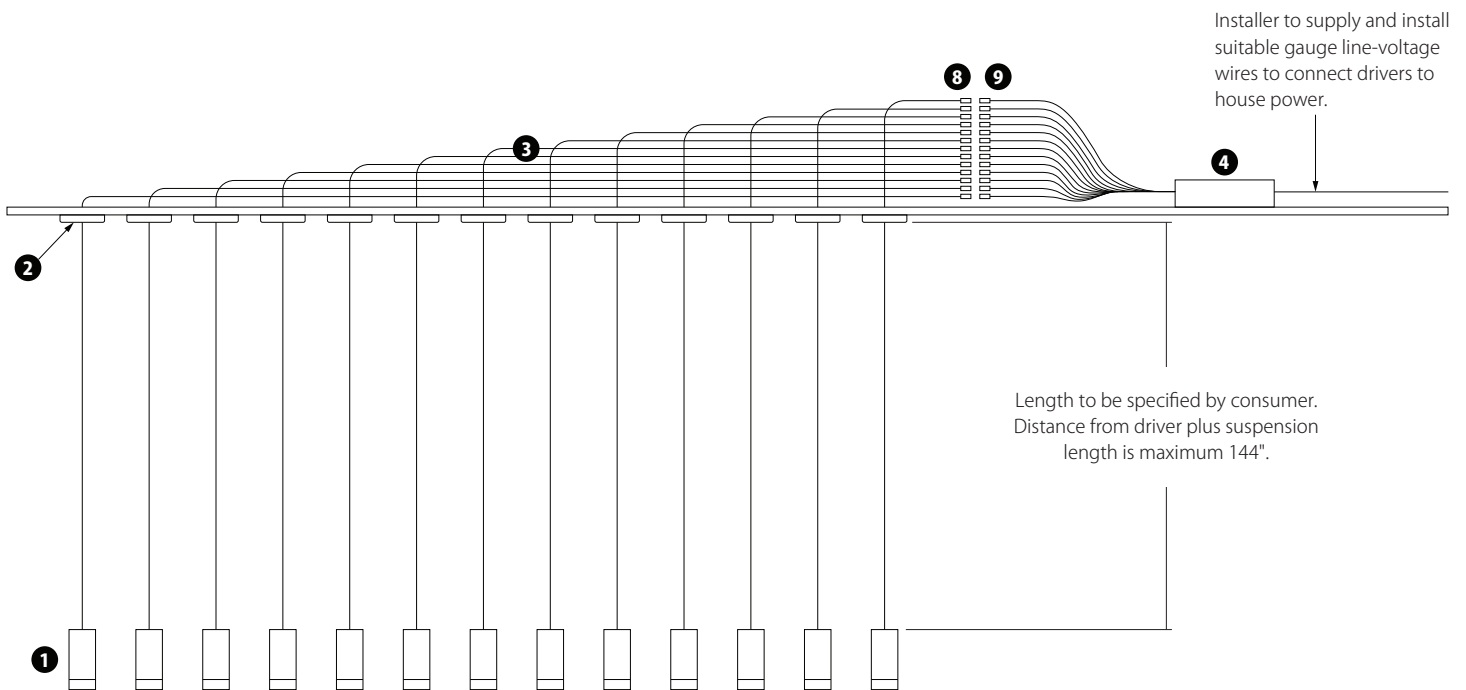

- 1 Pendant
- 2 Fascia Canopy
- 3 Each pendant has 12' of wire to connect to the remote driver and suspend the pendant
- 4 Universal 96W Driver inside of a remote housing (120–277V, TRIAC, ELV, and 0–10V dimming) driver located in remote housing
- 5 White power disconnect
Each pendant has a power disconnect located at the end, to be plugged into the wire harness attached to the driver.
Driver has a thirteen port harness at the end
- 6 Driver and wire harness

Fascia Canopy Detail

Fixture must be mounted to rigid ceiling material (sheet rock, fire rated plywood or similar) that can support the weight of the fixture and accept drywall anchors, expandable fasteners or similar structural fasteners.

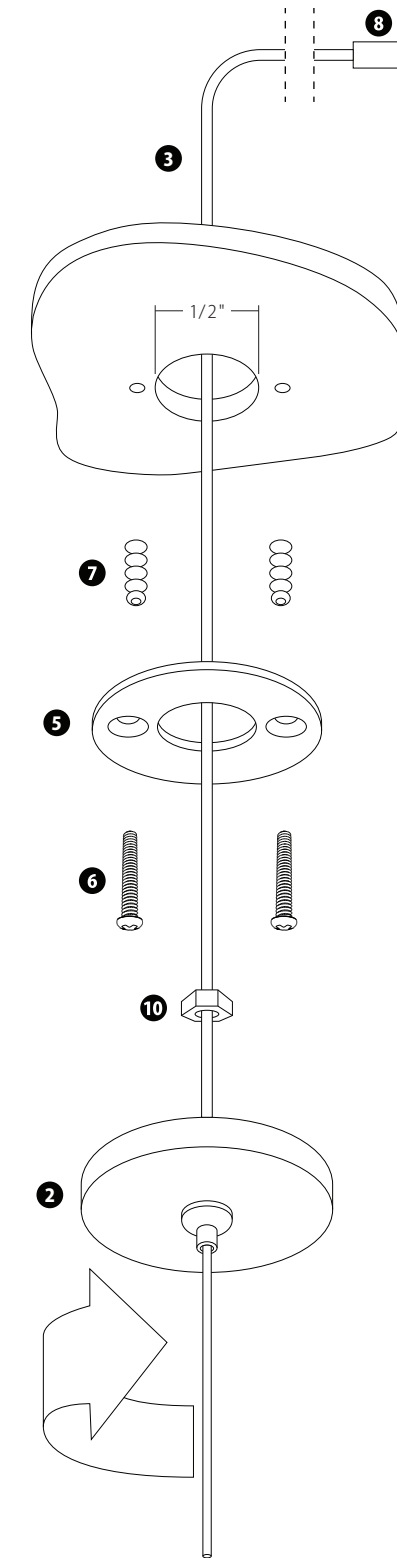

Recommended hole diameter for the ceiling hole is 1/2" but not bigger than 3/4".

- 2 The bottom assembly screws onto the top ceiling plate.
- 3 Each pendant has 12' of wire to connect to the remote driver. (no cutting/splicing required)
- 5 Top Plate, has two holes for mounting and threads onto the sides, to be used to mount the bottom assembly.
- 6 Each pendant needs two screws that are used to mount the pendant assembly. (to be provided by final installer)
- 7 Each pendant needs two screws that require an anchor to be mounted into the ceiling material. (to be provided by final installer)
- 8 Each pendant has a power disconnect located at the end, to be plugged into the wire harness attached to the driver.
- 10 Install the gripper in the mounting hole in the canopy cover. Pull the coaxial cable through the gripper to determine the desired height of pendant.