



CAUTION

Turn off the main power at the circuit breaker before installing the fixture in order to prevent possible shock. If you are unfamiliar with proper electrical wiring connections, obtain the services of a qualified electrician.

GENERAL

Read all instructions carefully for safe operation and installation.

All electrical connections must be in accordance with local and national electrical code (N.E.C.) standards.

Remove the fixture and mounting package from the box. Make sure no parts are missing by referencing the illustrations on these Installation Instructions. Please contact Blackjack Lighting at 847-941-0588 if any parts are missing or damaged.

This product is suitable for DAMP locations.

TABLE of CONTENTS

Suspended Aircraft Cable Mount	page 2
Suspended Stem Mount.	page 7
Flush Mount - Fixed / Floating Canopy.	page 12
Wall Mount Installation	page 18
LED Module Installation.	page 19
Spot Light Installation.	page 21
Pendant Adapter Installation.	page 23

SUSPENDED - AIRCRAFT CABLE MOUNT

1. INSTALL ELECTRICAL CONNECTOR

- a. Attach connector "A" (3) into the end of the track that will attach to end joiner (4). Push connector "A" (3) into channel (5) until the hole in end of the channel aligns with the hole in connector "A". [Please note; connector "A" will only fit correctly into one end of channel (5)]. Insert flat head screw (6) into connector "A" (3) and into the threaded hole in channel (5). Tighten screw (6) part way but not completely so it does not protrude through the back of channel (5).

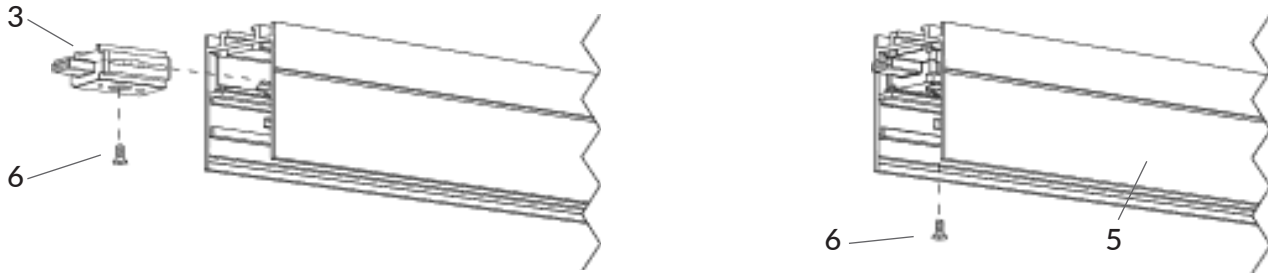

2. INSTALL END JOINER

- a. Loosen both set screws (7) from the tongue of end joiner (4). Slide end joiner (4) into channel (5) until it makes firm contact. While keeping this firmly in contact, tighten both set screws (7). Turn the channel over and tighten flat head screw (6) until connector "A" (3) is firmly held in place.
- b. Install the strain relief collar (46) onto the end joiner (4) by threading the low voltage cable (41) through the center mounting hole. Tighten the fastener firmly into the back of the end joiner (4) and tighten the side set screw to hold the electrical cable (41) in place.

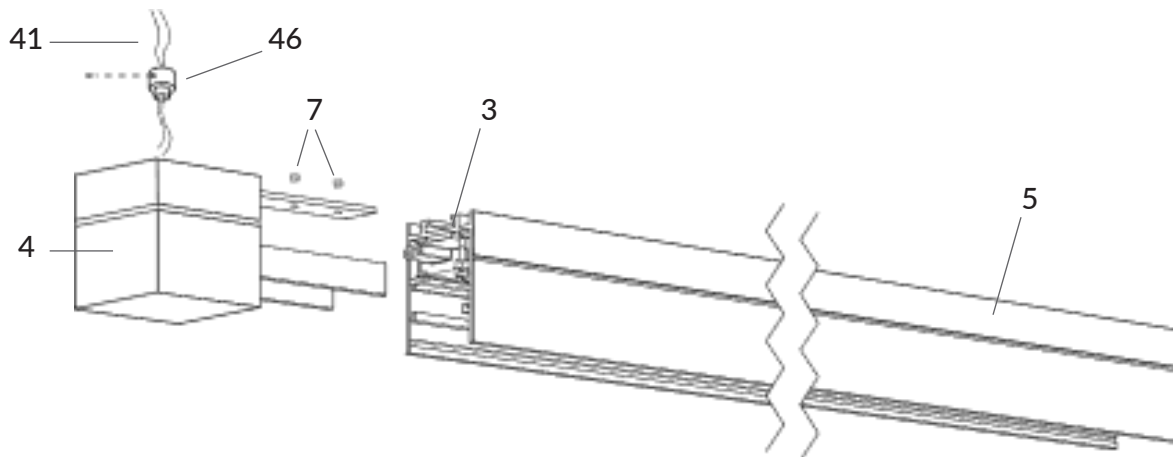

3. INSTALL AIRCRAFT CABLE MOUNTING BRACKET

- a. Determine the total number of mounting brackets (26) that are required for each channel (5):
1. A 23" to 47" length of channel (5) will require at least two mounting brackets (26).
 2. Lengths greater than 47" and up to 94" will require at least three mounting brackets (26).

When installed in a continuous row, each individual section of not more than 48" in length shall have at least one additional mounting bracket (26).

b. Mount first bracket for aircraft cable:

Install mounting bracket (26) into channel (5) and slide it as close as possible to end joiner (4).

Attach aircraft cable assembly; pull the aircraft cable (43) through the ball end support collar (44) until the ball end rests inside the collar. Insert aircraft cable (43) into aircraft cable gripper (42).

Attach locking ring (45) onto the end of the aircraft cable gripper (42), then attach it to mounting bracket (26). Tighten all the way down, then tighten locking ring (45) to secure it into the bracket (26). Lock bracket (26) in place with set screw (21).

c. Mount additional brackets for aircraft cable:

Additional brackets (26) may be required to be slid in the back of the channel (5) to support additional aircraft cables.

Attach Aircraft cable assembly to mounting bracket (26) as outlined above (in 3b).

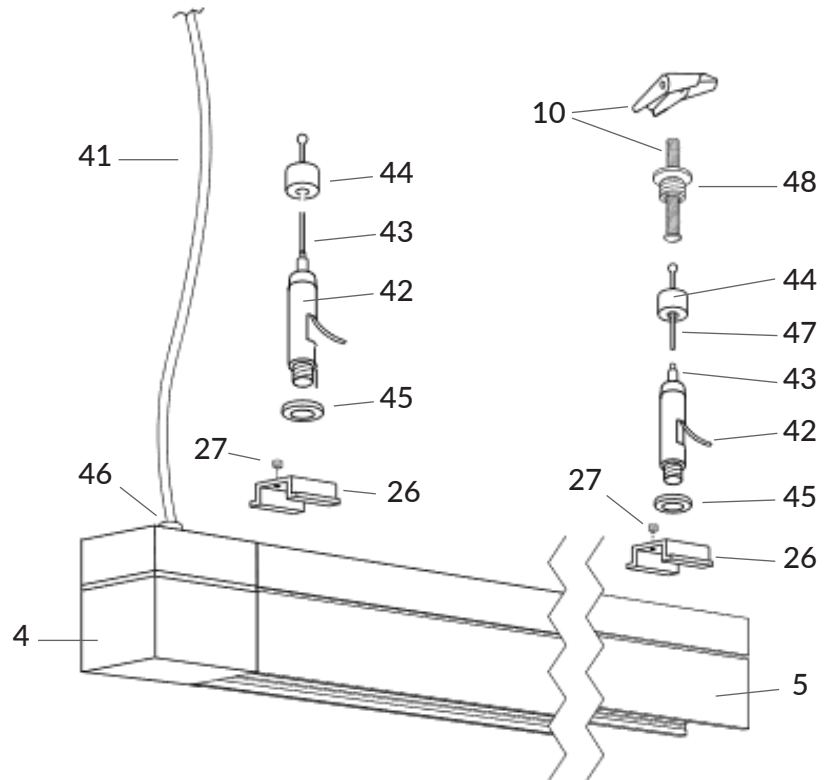

4A (OPTION 1) – PREPARE OPPOSITE END FOR SINGLE CHANNEL INSTALLATIONS

For single channel installations install the decorative endcap (13):

Slide the endcap into the channel (5) and insert a 5/16" flat head screw (24) into the base of the endcap and through the hole at the end of the channel (5).

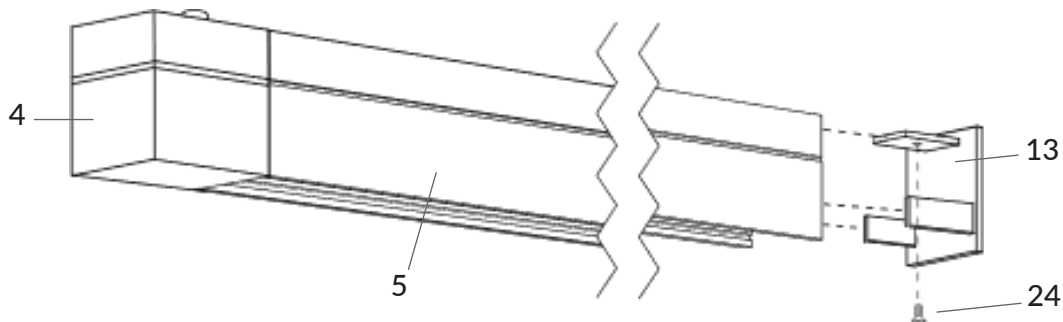

4B (OPTION 2) – PREPARE OPPOSITE CHANNEL END FOR EXTERNAL JOINER CONNECTION

For connection to additional channel sections (5) with an external joiner either ("L"/ "I"/ "T"/ "X" Joiner) (15):

- INSTALL CONNECTOR:** Attach connector "B" (14) into the end of the track that will attach to the external joiner (15). Push connector "B" (14) into the channel (5) until the hole in end of the channel aligns with the hole in connector "B".

[Please note: connector "B" will only fit correctly into one end of the channel (5)].

Insert a flat head screw (6) into connector "B" and into the threaded hole in Channel (5). Tighten screw (6) part way but not completely so it does not protrude through the back of the channel (5).

- b. **INSTALL JOINER:** Loosen both set screws (7) from the tongue of the external joiner (15). Slide the external joiner (15) into the channel (5) until it makes firm contact. While keeping the joiner (15) firmly in contact, tighten both of the set screws (7). Turn the channel over and tighten the flat head screw (6) until connector “B” (14) is firmly held in place.

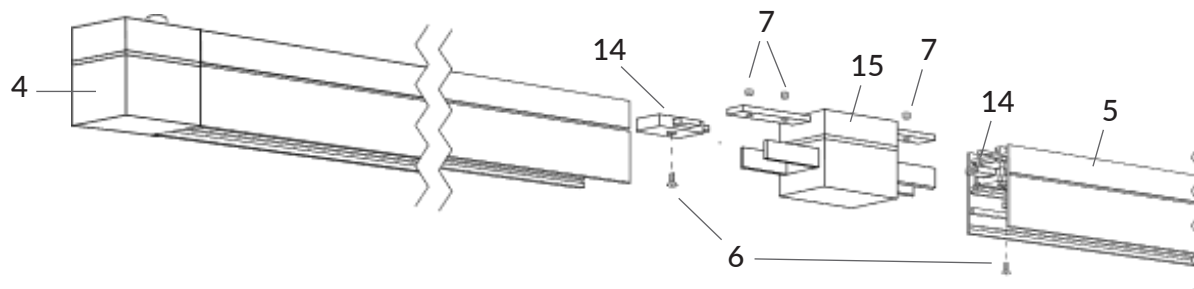

4C (OPTION 3) – PREPARE OPPOSITE CHANNEL END FOR INTERNAL JOINER CONNECTION

For connection to additional channel sections (5) with an internal joiner (16):

- a. **INSTALL CONNECTOR:** Attach one end of double connector “C” (17) into the end of the track that will attach to the internal joiner (16). Push double connector “C” (17) into the channel (5) until the hole in the end of channel aligns with the hole in one end of double connector “C”. [Please note; connector “C” will only fit correctly into one end of the channel (5)]. Insert a flat head screw (6) into connector “C” (17) and into the threaded hole in channel (5). Tighten part way but not completely so that the screw does not protrude through the back of the channel.
- b. **INSTALL JOINER:** Slide one top and two side pieces of the internal joiner (16) into the channel (5) and position it with half of the length of each of the three pieces of internal joiner (16) extending out from the end of the channel (5). Tighten the screws from the top piece and the two side pieces of the internal joiner (16) until it mounts firmly in place in the channel (5). Turn the channel over and tighten the flat head screws (6) until connector “C” (17) is firmly held in place.

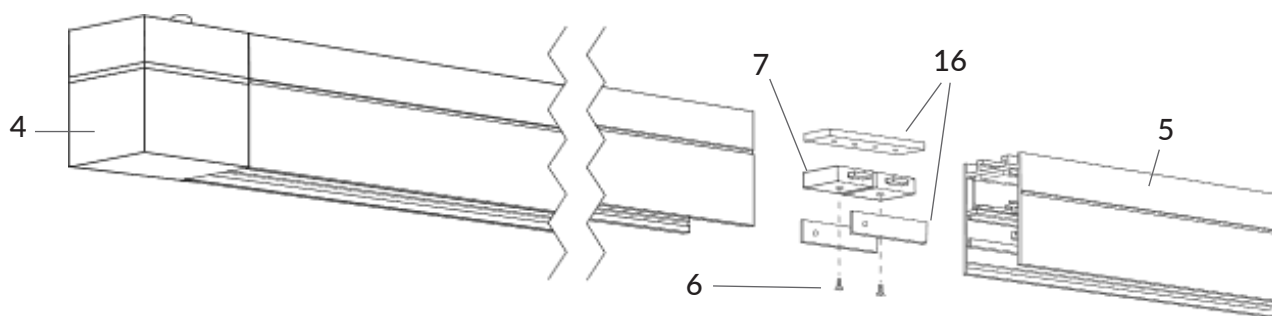

5. INSTALL BACKPLATE TO JUNCTION BOX

- a. Install the backplate (1, 9, 20 or 21) to the junction box (21).
- b. For the junction box cover plate (1): pull the two electrical low voltage wires (22) from remote driver (50) through backplate. Install cover plate (1) so that side mounted screw hole is facing the same direction as the channel (5).
- c. For the round and rectangular canopies: pull the line voltage supply wires (51) from junction box (12) through the backplate. Attach line voltage supply wires (51) to input wires from driver (40).

6. INSTALL AIRCRAFT CABLE / ELECTRICAL WIRE ASSEMBLY TO CANOPY COVER

- a. Pull the aircraft cable (43) through the ball end support collar (44) until the ball end rest inside the collar. Attach it to the center of the canopy, and secure it with the threaded hex fastener (23) from the inside of the ceiling canopy.

- b. Pull the length of the aircraft cable (43) through the gripper (42) until the approximate channel mounting height is achieved. Final cable length to be determined once the track is mounted to the ceiling.
- c. Insert the low voltage cable (41) from the end joiner (4) through the strain relief collar (46) and into the ceiling canopy (29, 35, 38, or 32)
- d. Determine the approximate length of electrical cable (41) (it is recommended to allow the electrical cable to have some slack once installed). Temporarily tighten the set screw on the strain relief collar (46) attached to the canopy. Cut the excess cable (41) on the inside of canopy (leaving some extra length for later adjustment) or wrap excess wire around bracket (53) on canopy (29) or bracket (54) on canopy (35).

7. INSTALL AIRCRAFT CABLE CEILING SUPPORTS

- a. Measure the distance between the first mounting bracket (26) (underneath the center of the canopy) and the next mounting bracket (26). Then measure the distance between each of the remaining mounting brackets (26) along the channel (5). Mark the distance between the canopy center and the first mounting bracket on the ceiling. Then mark the rest of the measured bracket locations in a straight line on the ceiling.
- b. Unscrew the aircraft cable ball end support (47) attached to the ceiling mount bracket (48). Align the ceiling mount bracket with the marks made on the ceiling and mark the center hole location on the ceiling.
- c. Insert a ceiling anchor (10) rated to support at least 40 pounds to the ceiling mount location (anchor and fastener not included). It is recommended to use a No. 10 (3/16" dia.) toggle bolt ceiling anchor (in sheetrock applications) or a No. 10 round head screw (3/16" dia.) into a solid surface. Tighten the ceiling mount bracket (48) until it rests firmly against the ceiling.

8. CONNECT ELECTRICITY

- a. Attach the low voltage fixture wires (41) coming from the end joiner (4) through ceiling canopy (29, 35, 32, or 38) to the low voltage wire (34) coming from integrally mounted driver (50) using quick connector (52). Low voltage fixture wires can also be attached to the low voltage wires (22) coming through the junction box (12) from remote mounted driver (50).

[NOTE: DO NOT CONNECT THE LOW VOLTAGE (24v) ELECTRICAL WIRING (41) COMING FROM THE END JOINER (4) TO A LINE VOLTAGE (120-277v) INPUT FROM THE JUNCTION BOX (12)]

9. ATTACH CEILING CANOPY

- a. For junction box cover plate (29); align cover (29) to side openings in backplate (1) Attach with a quarter turn motion. Lock the front cover (29) to the backplate (1) by inserting the side mounted backplate screw (2).
- b. For shallow canopy (35); Attach driver (50) and its rear disk to the support bracket (54) with two screws (55). Push the front canopy (35) up to the canopy backplate (32) until the canopy is firmly positioned against the ceiling, and then lock into position with three side finials (49)
- c. For deep canopy (38); Secure the internal support bracket (37) to the canopy backplate (37) with the two finials (36) on either side. Then install the two finials (39) holding the deep round cover plate (38) to the mounting bracket (37)
- d. For rectangular canopy (32); Attach the canopy cover (32) and secure it to the canopy backplate (21) with the four screws (19).

10. ATTACH AIRCRAFT CABLE TO CEILING SUPPORTS

- a. Mount each aircraft cable ball end support (47) to the ceiling mount bracket (48) and hand fasten them together.
- b. Adjust the length of each aircraft cable (43) to achieve a horizontally mounted channel (5). To raise the channel, pull the cable (43) through the gripper (42), or push down the top of the gripper to release more cable to lower the channel (5).
- c. Once all of the aircraft cable wires are adjusted to the proper length take a cable cutting pliers and cut the excess aircraft cable (43) coming out the side of the gripper (42).

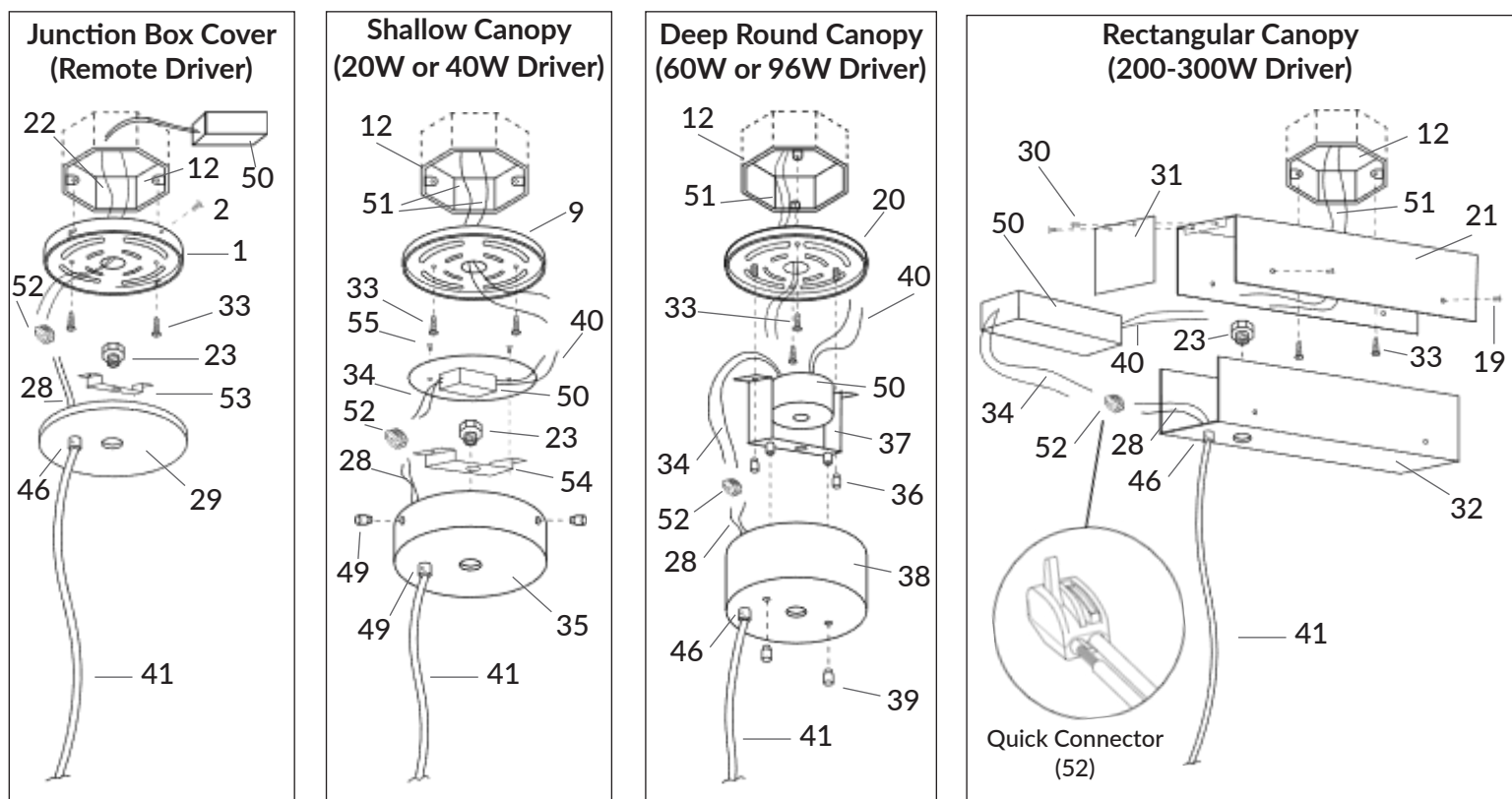

1. JUNCTION BOX COVER BACKPLATE
2. JUNCTION BOX COVER BACKPLATE SCREW
3. CONNECTOR "A"
4. END JOINER
5. CHANNEL
6. FLAT HEAD SCREW
7. JOINER SET SCREWS
8. INTERNAL SUPPORT THREADED POSTS
9. SHALLOW CANOPY BACKPLATE
10. CEILING ANCHOR (by others)
11. DEEP ROUND CANOPY THREADED POSTS
12. JUNCTION BOX
13. DECORATIVE ENDCAP
14. CONNECTOR "B"
15. EXTERNAL JOINER
16. INTERNAL JOINER
17. DOUBLE ENDED CONNECTOR "C"
18. LOW VOLTAGE CABLE FIXTURE WIRES
19. RECTNGULAR CANOPY SCREWS
20. DEEP ROUND CANOPY BACKPLATE

21. RECTANGULAR CANOPY BACKPLATE
22. LOW VOLTAGE WIRES FROM REMOTE DRIVER
23. THREADED HEX FASTENER
24. END CAP FLAT HEAD SCREW
25. DEEP ROUND CANOPY THREADED POSTS
26. MOUNTING BRACKET
27. SET SCREW
28. LINE VOLTAGE WIRES FROM END JOINER
29. JUNCTION BOX COVER PLATE
30. RECTANGULAR CANOPY END COVER SCREWS
31. RECTANGULAR CANOPY END COVER
32. RECTANGULAR CANOPY COVER
33. MOUNTING SCREWS
34. LOW VOLTAGE WIRES FROM DRIVER
35. SHALLOW ROUND CANOPY COVER
36. INTERNAL SUPPORT FINIALS
37. INTERNAL SUPPORT MOUNTING BRACKET
38. DEEP ROUND CANOPY COVER

39. DEEP ROUND CANOPY DECORATIVE FINIALS
40. LINE VOLTAGE WIRE FROM DRIVER
41. ELECTRICAL CABLE
42. GRIPPER
43. AIRCRAFT CABLE
44. SPECIAL CANOPY MOUNT BRACKET
45. LOCKING RING
46. END JOINER STRAIN RELIEF COLLAR
47. CEILING MOUNT BRACKET
48. SUPPORT ASSEMBLY CEILING MOUNT BRACKET
49. SHALLOW CANOPY DECORATIVE FINIALS
50. DRIVER
51. LINE VOLTAGE SUPPLY WIRES FROM JUNCTION BOX
52. QUICK CONNECTOR
53. JUNCTION BOX COVER PLATE U-BRACKET
54. SHALLOW CANOPY U-BRACKET
55. SHALLOW CANOPY U-BRACKET SCREW

SUSPENDED - STEM MOUNT

1. INSTALL ELECTRICAL CONNECTOR

- a. Attach connector "A" (3) into the end of the track that will attach to end joiner (4). Push connector "A" (3) into channel (5) until the hole in end of the channel aligns with the hole in connector "A".

[Please note: connector "A" will only fit correctly into one end of channel (5)].

Insert flat head screw (6) into connector "A" (3) and into the threaded hole in channel (5). Tighten screw (6) part way but not completely so it does not protrude through the back of channel (5).

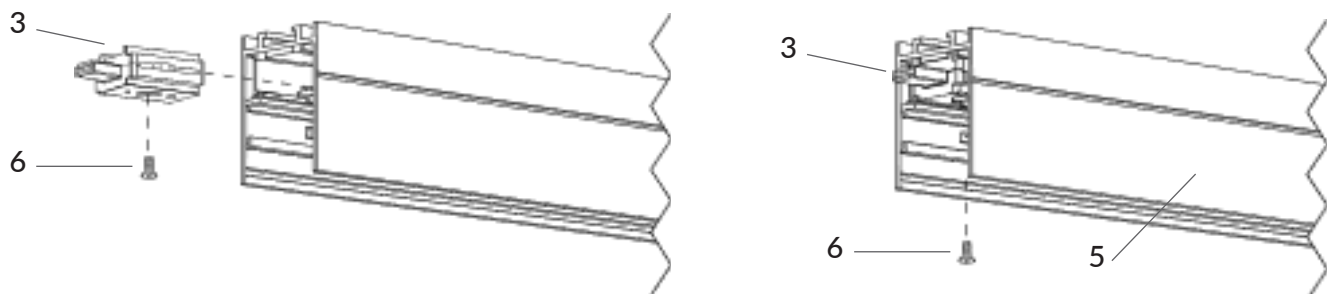

2. INSTALL END JOINER

- a. Loosen both set screws (7) from the tongue of end joiner (4). Slide end joiner (4) into channel (5) until it makes firm contact. While keeping this firmly in contact, tighten both set screws (7). Turn the channel over and tighten flat head screw (6) until connector "A" (3) is firmly held in place.

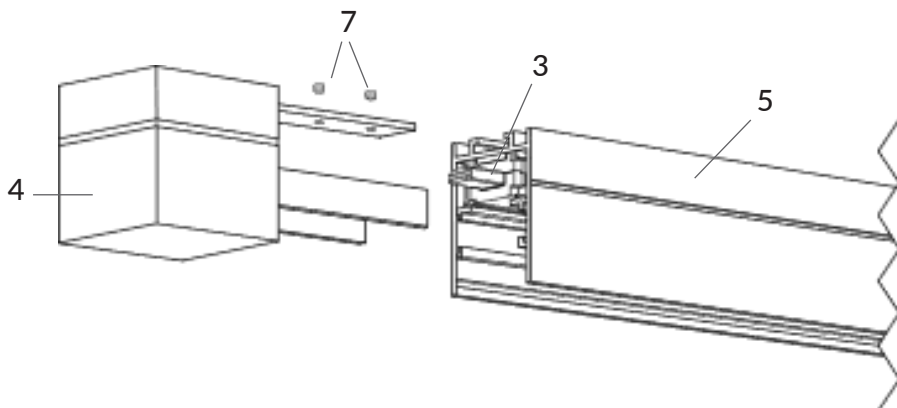

3. INSTALL STEM MOUNTING BRACKET

- a. Determine the total number of mounting brackets (26) that are required for each channel (5):

1. A 23" or 47" length of channel (5) will require at least two stem mounting locations.

2. Lengths greater than 47" and up to 94" will require at least three stem mounting locations.

3. When installed in a continuous row, each individual section of not more than 48" in length shall have an additional stem mounting location.

- b. Mounting location for stem with power cable: The stem (23) that carries the electrical power will mount to the top of the end joiner (4). See step 6.

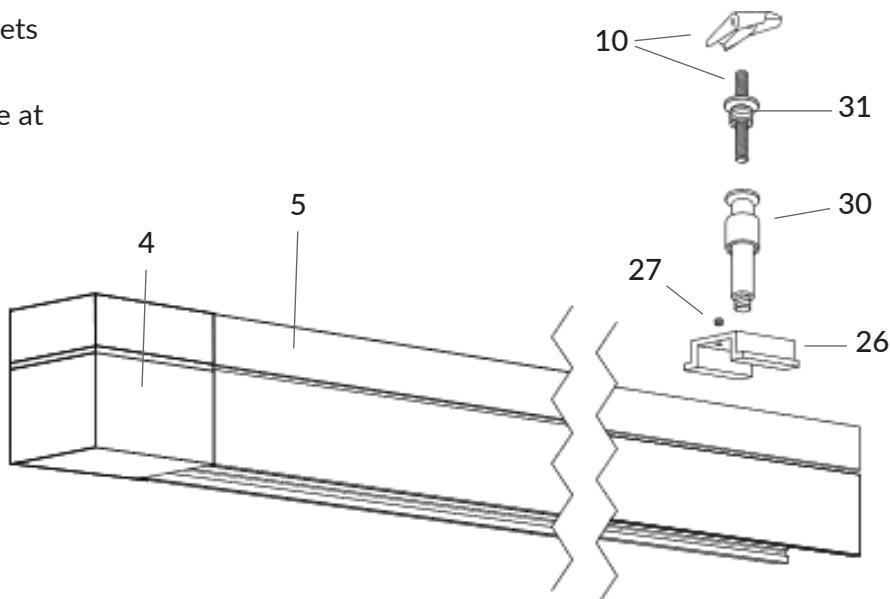

- c. Mount additional brackets for Stem: Brackets (26) may be required to be slid in the back of the channel (5) to mount additional stems that are not powered. Insert the bracket (26) and locate as required. Tighten the set screw (27) on the bracket (26).

4A (OPTION 1) – PREPARE OPPOSITE END FOR SINGLE CHANNEL INSTALLATIONS

For single channel installations:

Install the decorative endcap(13) by sliding the endcap into the channel (5) and inserting a 5/16" flat head screw (24) into the base of the endcap and through the hole at the end of the channel (5).

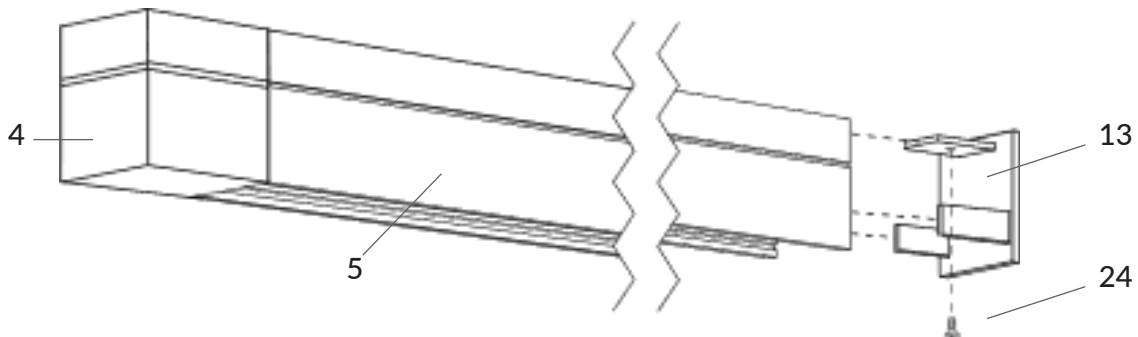

4B (OPTION 2) – PREPARE OPPOSITE CHANNEL END FOR EXTERNAL JOINER CONNECTION

For connection to additional channel sections (5) with an external joiner either ("L"/ "I"/ "T"/ "X" Joiner) (15):

- a. **INSTALL CONNECTOR:** Attach connector "B" (14) into the end of the track that will attach to the external joiner (15). Push connector "B" (14) into the channel (5) until the hole in end of the channel aligns with the hole in connector "B". [Please note; connector "B" will only fit correctly into one end of the channel (5)]. Insert a flat head screw (6) into connector "B" and into the threaded hole in Channel (5). Tighten screw (6) part way but not completely so it does not protrude through the back of the channel (5).
- b. **INSTALL JOINER:** Loosen both set screws (7) from the tongue of the external joiner (15). Slide the external joiner (15) into the channel (5) until it makes firm contact. While keeping the joiner (15) firmly in contact, tighten both of the set screws (7). Turn the channel over and tighten the flat head screw (6) until connector "B" (14) is firmly held in place.

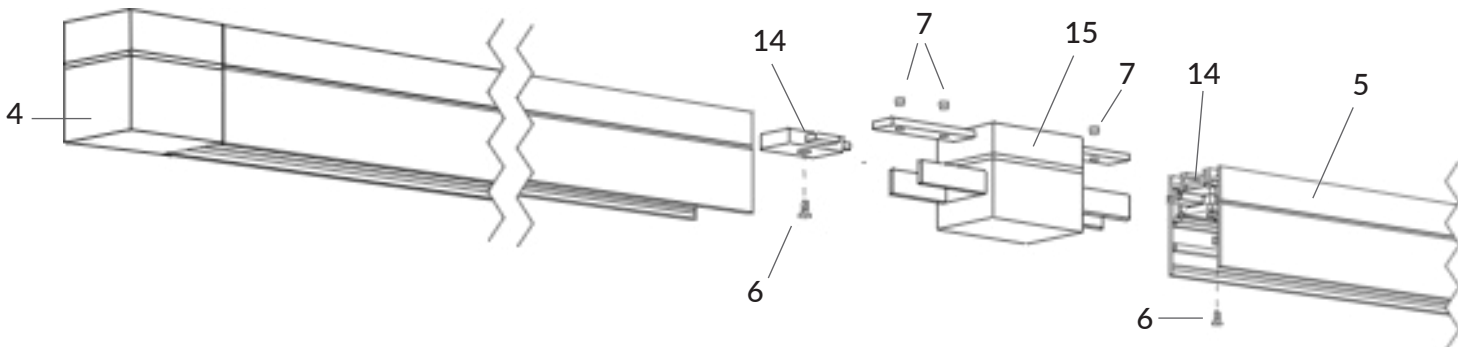

4C (OPTION 3) – PREPARE OPPOSITE CHANNEL END FOR INTERNAL JOINER CONNECTION

For connection to additional channel sections (5) with an internal joiner (16):

- a. **INSTALL CONNECTOR:** Attach one end of double connector “C” (17) into the end of the track that will attach to the internal joiner (16). Push double connector “C” (17) into the channel (5) until the hole in the end of channel aligns with the hole in one end of double connector “C”. [Please note; connector “C” will only fit correctly into one end of the channel (5)]. Insert a flat head screw (6) into connector “C” (17) and into the threaded hole in Channel (5). Tighten part way but not completely so that the screw does not protrude through the back of the channel.
- b. **INSTALL JOINER:** Slide one top and two side pieces of the internal joiner (16) into the channel (5) and position it with half of the length of each of the three pieces of internal joiner (16) extending out from the end of the channel (5). Tighten the screws from the top piece and the two side pieces of the internal joiner (16) until it mounts firmly in place in the channel (5). Turn the channel over and tighten the flat head screws (6) until connector “C” (17) is firmly held in place.

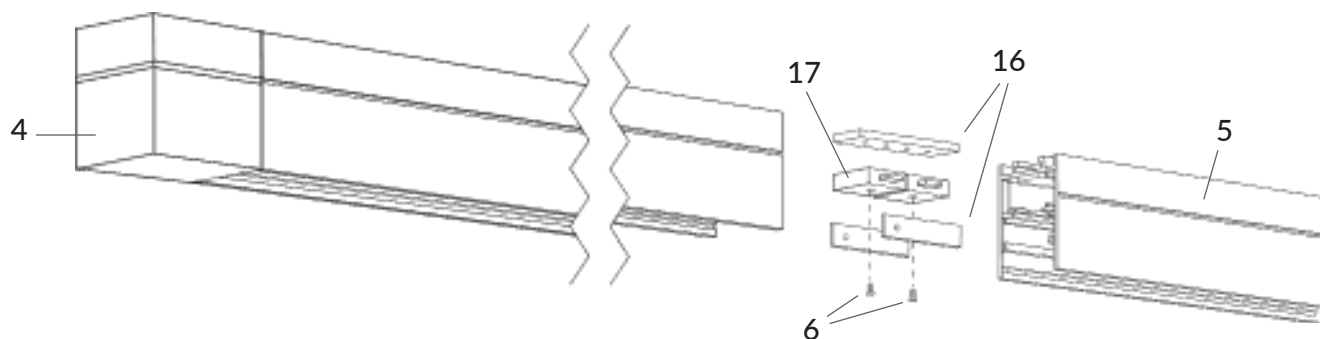

5. INSTALL BACKPLATE TO JUNCTION BOX

- a. Install the backplate (1, 9, 32 or 39) to the junction box (12).
- b. For the junction box cover plate (1): pull the two electrical low voltage wires (22) from remote driver (19) Through the backplate.
- c. For the round and rectangular canopies: pull the line voltage supply wires (25) from junction box (12) through the backplate. Attach line voltage supply wires (25) to input wires from driver (45).

6. INSTALL STEM MOUNT / ELECTRICAL WIRE ASSEMBLY TO CANOPY COVER

- a. Insert the two low voltage wires (28) from the end joiner through the stem mounted to the canopy cover (18, 29, 38, or 43)
- b. Thread the stem from the canopy cover into the top of the end joiner (4) until it is firmly tightened. Attach the other end of the stem to the canopy cover (18, 29, 38, or 43) using hex threaded connector (47). Cut the excess wire (28) on the inside of canopy (leaving some extra length for later adjustment if needed), or wrap excess wire around bracket (48) on canopy (18).

7. INSTALL STEM SUPPORTS

- a. Mount the additional non-powered stem (30) (along with the top threaded stem top (31)) into bracket(s) (26) that were previously mounted on the rear of channel (5). Tighten firmly to lock in place
- b. Temporarily hold the assembled channel with the canopy cover (18, 29, 38, or 43) in place over the mating backplate. With the non-powered stems (30) and threaded stem top (31) touching the ceiling, place a mark centered at each stem location.
- c. Unscrew stem top (31), align it with the marks made on the ceiling and mark the center hole location on the ceiling.

- d. Insert a ceiling anchor (10) rated to support at least 40 pounds into each stem top mounting location (anchor and fastener not included). It is recommended to use a No. 10 (3/16" dia.) toggle bolt ceiling anchor (in sheetrock applications) or a No. 10 round head screw (into a solid surface). Mount the fastener through the stem top (31) and fasten it firmly to the ceiling.

8. CONNECT ELECTRICITY

Attach the low voltage fixture wires (28) coming from the end joiner (4) through ceiling canopy (18, 29, 38, or 43) to the low voltage wire (34) coming from integrally mounted driver (45). Connect with quick connector (20). Low voltage fixture wires can also be attached to the low voltage wires (22) coming through the junction box (12) from remote mounted driver (19).

[NOTE: DO NOT CONNECT THE LOW VOLTAGE (24v) ELECTRICAL WIRING (28) COMING FROM THE END JOINER (4) TO A LINE VOLTAGE (120-277v) INPUT FROM THE JUNCTION BOX (12)]

9. ATTACH CEILING CANOPY

- a. For junction box cover plate; Install the two decorative finials (11) holding the junction box cover plate (29) to the two threaded studs (2) attached to the support bracket (1).
- b. For shallow canopy; Attach driver (45) and its rear disk to the support bracket (48) with two screws (49). Push the front canopy (18) up to the canopy backplate (32) until the canopy is firmly positioned against the ceiling, and then lock into position with three side finials (46).
- c. For deep canopy; Secure the internal support bracket (37) to the canopy backplate (9) with the two finials (21) on either side. Then install the two finials (11) holding the deep round cover plate (38) to the mounting bracket (37).
- d. For rectangular canopy, attach canopy cover (43) and secure it to the canopy backplate (39) with four screws (44).

10. ATTACH STEMS TO CEILING SUPPORTS

- a. Align the non-powered stems (30) with the ceiling mounted stem top (31). Hand tighten the collar on the top of each stem (30) and screw it onto the stem top (31) until the channel is firmly positioned against the ceiling.

**Junction Box Cover
(Remote Driver)**

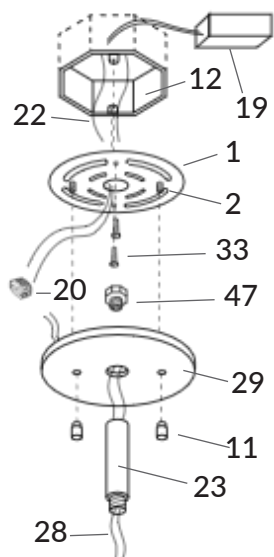

**Shallow Canopy
(20W or 40W Driver)**

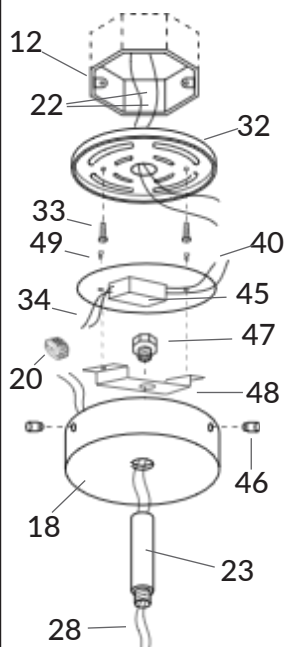

**Deep Round Canopy
(60W or 96W Driver)**

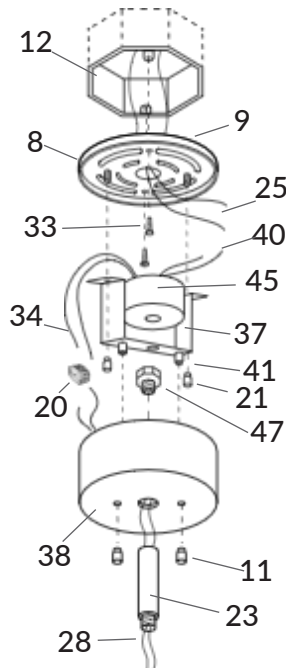

**Rectangular Canopy
(200-300W Driver)**

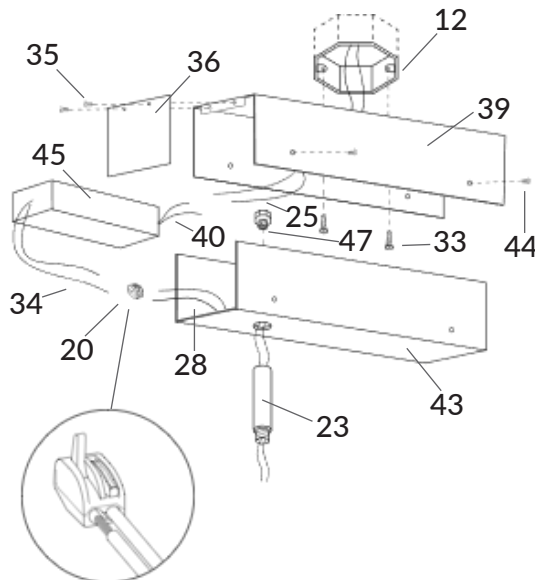

1. JUNCTION BOX COVER PLATE SUPPORT BRACKET
2. JUNCTION BOX COVER PLATE THREADED STUDS
3. CONNECTOR "A"
4. END JOINER
5. CHANNEL
6. FLAT HEAD SCREW
7. JOINER SET SCREWS
8. DEEP CANOPY THREADED BACKPLATE POSTS
9. DEEP ROUND CANOPY BACKPLATE
10. CEILING ANCHOR (by others)
11. DECORATIVE FINIALS
12. JUNCTION BOX
13. DECORATIVE ENDCAP
14. CONNECTOR "B"
15. EXTERNAL JOINER
16. INTERNAL JOINER
17. DOUBLE ENDED CONNECTOR "C"

18. SHALLOW ROUND CANOPY COVER
19. REMOTE DRIVER
20. QUICK CONNECTOR
21. DEEP CANOPY MOUNTING BRACKET FINIALS
22. LOW VOLTAGE WIRES FROM REMOTE DRIVER
23. ELECTRICAL STEM
24. END CAP FLAT HEAD SCREW
25. LINE VOLTAGE WIRES FROM JUNCTION BOX
26. MOUNTING BRACKET
27. SET SCREW
28. LOW VOLTAGE WIRES FROM END JOINER
29. JUNCTION BOX COVER PLATE
30. NON-POWERED STEM
31. THREADED STEM TOP
32. SHALLOW CANOPY BACKPLATE
33. MOUNTING SCREWS

34. LOW VOLTAGE WIRES FROM DRIVER
35. RECTANGULAR CANOPY ENDPLATE SCREWS
36. RECTANGULAR CANOPY ENDPLATE
37. DEEP CANOPY INTERNAL SUPPORT MOUNTING BRACKET
38. DEEP ROUND CANOPY COVER
39. RECTANGULAR CANOPY BACKPLATE
40. LINE VOLTAGE WIRES FROM DRIVER
41. DEEP CANOPY INTERNAL SUPPORT THREADED POSTS
43. RECTANGULAR CANOPY COVER
44. RECTANGULAR CANOPY SCREWS
45. DRIVER
46. SHALLOW ROUND CANOPY FINIALS
47. ELECTRICAL STEM THREADED CONNECTOR
48. SHALLOW CANOPY U-BRACKET
49. SHALLOW CANOPY U-BRACKET SCREWS

FLUSH MOUNT – FIXED FLOATING CANOPY

1. INSTALL ELECTRICAL CONNECTOR

- a. Attach connector “A” (3) into the end of the track that will attach to end joiner (4). Push connector “A” (3) into channel (5) until the hole in end of the channel aligns with the hole in connector “A”.

[Please note: connector “A” will only fit correctly into one end of channel (5)].

Insert flat head screw (6) into connector “A” (3) and into the threaded hole in channel (5). Tighten screw (6) part way but not completely so it does not protrude through the back of channel (5).

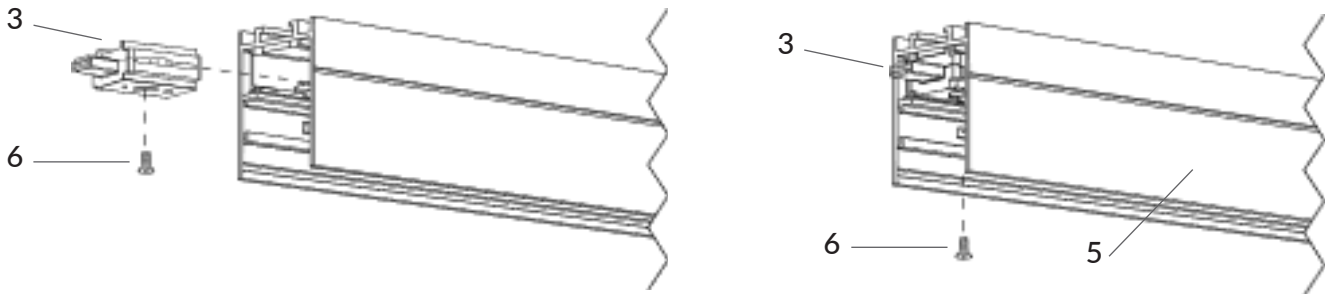

2. INSTALL END JOINER

- a. Loosen both set screws (7) from the tongue of end joiner (4). Slide end joiner (4) into channel (5) until it makes firm contact. While keeping this firmly in contact, tighten both set screws (7). Turn the channel over and tighten flat head screw (6) until connector “A” (3) is firmly held in place.

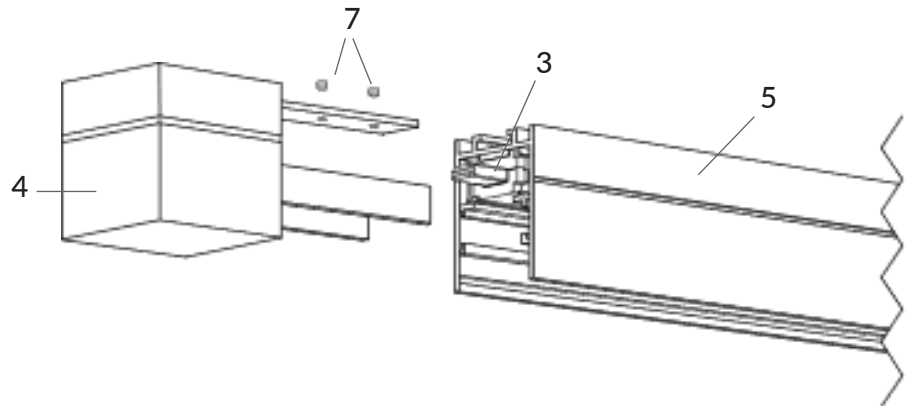

3. INSTALL FLAT J-BOX COVER

- a. Install the flat junction box cover plate (9) for Flush Mount/Fixed Canopy only:

Install the flat junction box cover (9) onto end joiner (4) by threading the low voltage electrical wires (11) through the center mounting hole and then through the threaded hex nipple (8). Tighten the threaded hex nipple (8) firmly into the back of the end joiner (4) until the flat junction box cover plate (9) has its two mounting holes located on either side of the channel, and is aligned parallel with the end joiner.

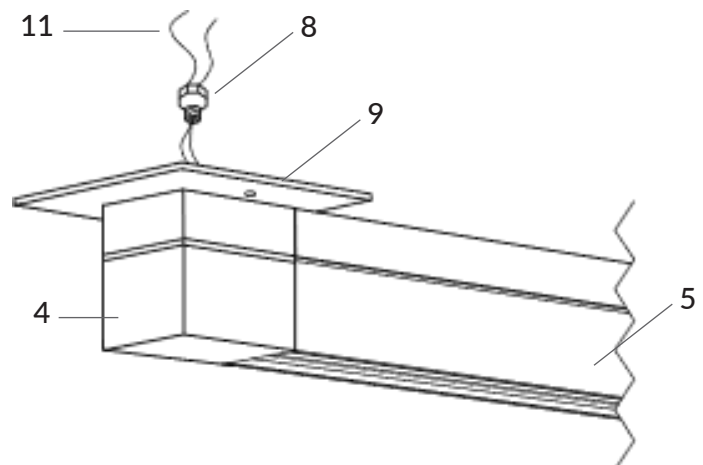

4A (OPTION 1) – PREPARE OPPOSITE END FOR SINGLE CHANNEL INSTALLATIONS

For single channel installations:

Install the decorative endcap (13) by sliding the endcap into the channel (5) and inserting a 5/16" flat head screw (24) into the base of the endcap and through the hole at the end of the channel (5).

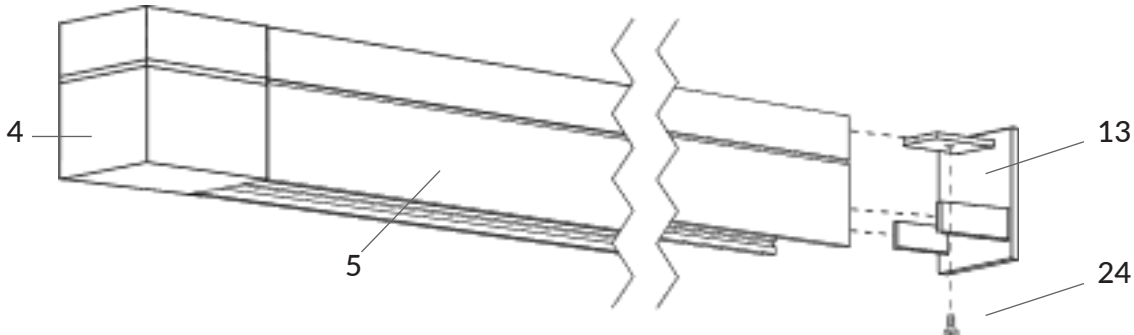

4B (OPTION 2) PREPARE OPPOSITE CHANNEL END FOR EXTERNAL JOINER CONNECTION

For connection to additional channel sections (5) with an external joiner either ("L"/ "I"/ "T"/ "X" Joiner) (15):

- INSTALL CONNECTOR:** Attach connector "B" (14) into the end of the track that will attach to the external joiner (15). Push connector "B" (14) into the channel (5) until the hole in end of the channel aligns with the hole in connector "B". [Please note; connector "B" will only fit correctly into one end of the channel (5)]. Insert a flat head screw (6) into connector "B" and into the threaded hole in Channel (5). Tighten screw (6) part way but not completely so it does not protrude through the back of the channel (5).
- INSTALL JOINER:** Loosen both set screws (7) from the tongue of the external joiner (15). Slide the external joiner (15) into the channel (5) until it makes firm contact. While keeping the joiner (15) firmly in contact, tighten both of the set screws (7). Turn the channel over and tighten the flat head screw (6) until connector "B" (14) is firmly held in place.

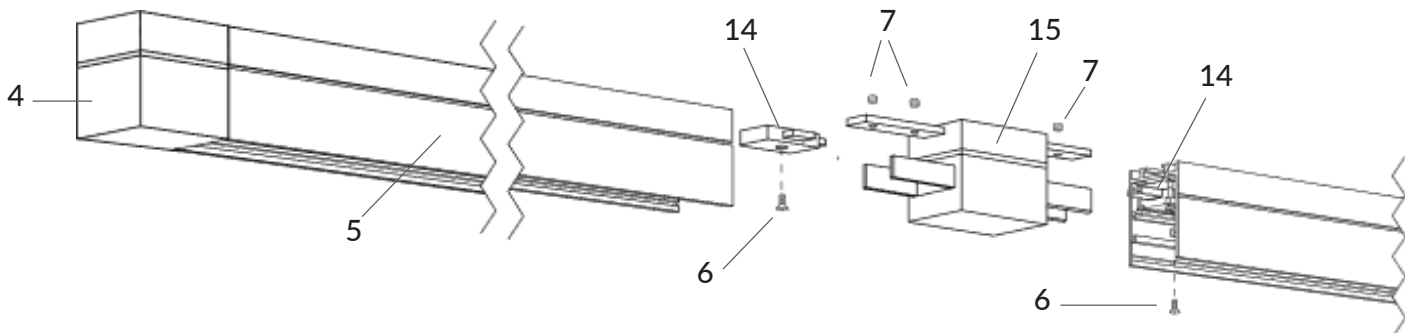

4C (OPTION 3) – PREPARE OPPOSITE CHANNEL END FOR INTERNAL JOINER CONNECTION

For connection to additional channel sections (5) with an internal joiner (16):

- INSTALL CONNECTOR:** Attach one end of double connector "C" (17) into the end of the track that will attach to the internal joiner (16). Push double connector "C" (17) into the channel (5) until the hole in the end of channel aligns with the hole in one end of double connector "C". [Please note; connector "C" will only fit correctly into one end of the channel (5)]. Insert a flat head screw (6) into connector "C" (17) and into the threaded hole in channel (5). Tighten part way but not completely so that the screw does not protrude through the back of the channel.

- b. **INSTALL JOINER:** Slide one top and two side pieces of the internal joiner (16) into the channel (5) and position it with half of the length of each of the three pieces of internal joiner (16) extending out from the end of the channel (5). Tighten the screws from the top piece and the two side pieces of the internal joiner (16) until it mounts firmly in place in the channel (5). Turn the channel over and tighten the flat head screws (6) until connector "C" (17) is firmly held in place.

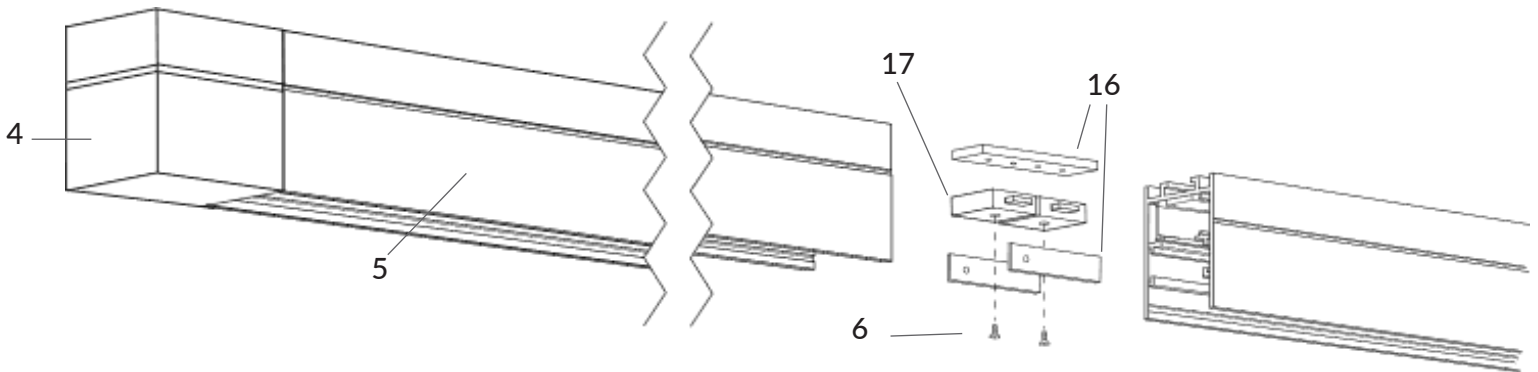

5A. INSTALL FLUSH BACKPLATE

Install the backplate (1) to the junction box (12) with the two supplied mounting screws (27). Make sure the two threaded studs (2) stick out away from the junction box (12) and are positioned to be on either side of channel (5) (when installed).

5B. INSTALL FLOATING BACKPLATE

Remove front canopy cover (19) by loosening the two threaded finials (20). Install the floating canopy backplate (18) to junction box (12) with the two supplied mounting screws (27).

6. MOUNTING CHANNEL TO CEILING

- Take the channel (5) with the connected end joiner(s) and temporarily mount them in place against the ceiling allowing the two threaded studs (2) from backplate (1) to go through the holes in the junction box cover (9).
- Temporarily hold the assembled channel in place against the ceiling. Place a mark on the ceiling at the selected hole locations on the channel (5). For 23" or 47" length channel (5) select at least two mounting hole locations. For lengths greater than 47" and up to 94" select at least three mounting hole locations. When installed in a continuous row, each individual section of not more than 48" in length shall have an additional support.
- Remove the channel (5) with the connected end joiner(s). Use a ceiling anchor (10) rated to support at least 40 pounds at each mounting location (anchor and fastener not included). It is recommended to use a No. 10 (3/16" dia.) toggle bolt ceiling anchor (in sheetrock applications) or a No. 10 (3/16" dia.) round head screw (into a solid surface).

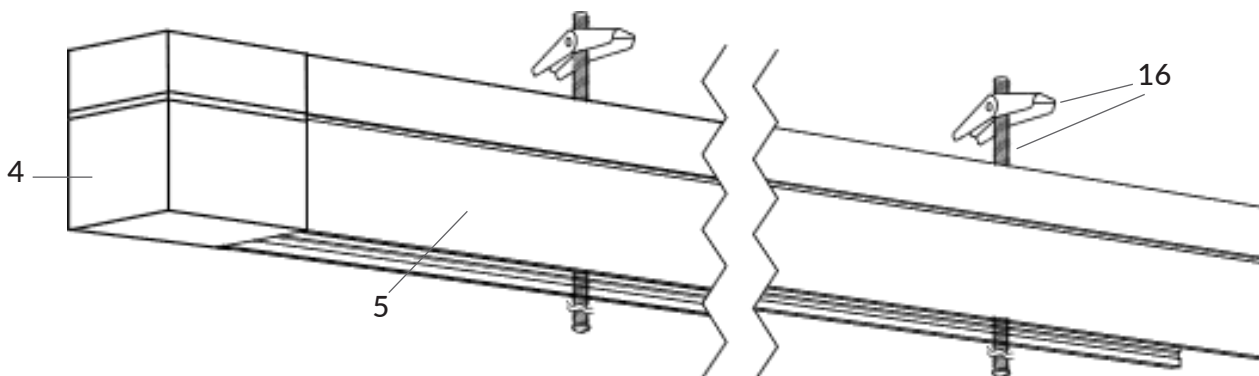

7A. CONNECTING ELECTRICITY FOR FLUSH MOUNT

- Attach the low voltage electrical wires (11) coming from the end joiner (4) to the low voltage wires (29) coming through the junction box (12) and connecting to a remote LED driver (28) using quick connector (30).

[NOTE: DO NOT CONNECT THE LOW VOLTAGE (24v) ELECTRICAL WIRING (11) COMING FROM THE END JOINER (4) TO A LINE VOLTAGE (120-277v) INPUT FROM THE JUNCTION BOX (12)]

- Place channel (5) and the joiner(s) and align with backplate (1) against the ceiling (Note: Toggle ceiling anchors (10) should be inserted into channel (5) and into ceiling before placing the channel up to the ceiling). Once channel (5) is in place, tighten the selected fastener to the ceiling until the channel is firmly positioned against the ceiling.
- Install the two finials (20) holding the junction box coverplate (9) to the backplate (1).

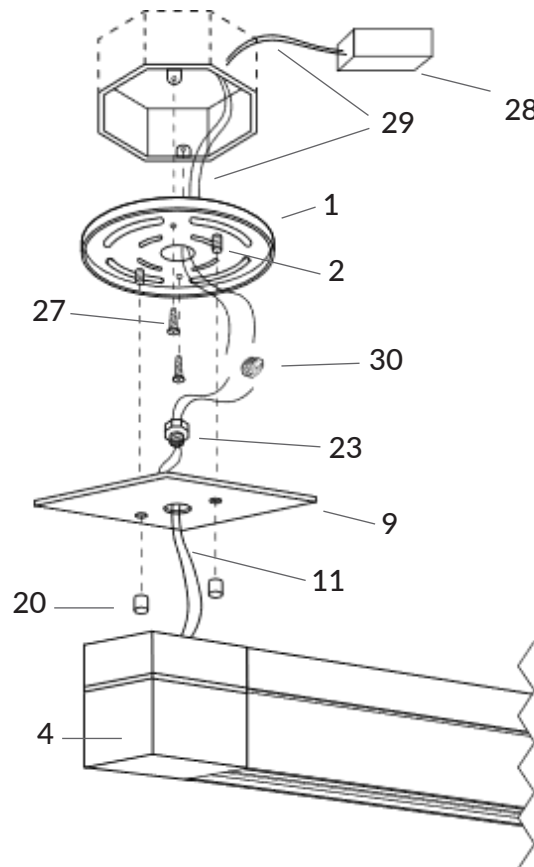

7B. CONNECTING ELECTRICITY FOR REMOTE MOUNTED DRIVER WITH FLOATING CANOPY

- Pull the low voltage electrical wires (29) coming through the junction box (12) through the back of the floating canopy backplate (18).
- Insert mounting brackets (32) in the rear of channel (5) to retain the loose wire between end joiner (4) to floating canopy backplate (18). Also insert one or two mounting brackets (32) as spacers on the other side of the floating canopy to allow the channel (5) to be level once attached to the ceiling.
- Feed the two low voltage wires (11) through the mounting brackets (32) and cut the two wires to the proper length so it will fit with only a small amount of slack when connected inside the junction box (12) above the floating canopy (18). Push low voltage wires (11) into lip in extrusion (5) with tip of screwdriver.
- Using quick connectors (30) connect the low voltage wire (11) to low voltage wire (29) coming from remote driver (28). Push extra wire and quick connector into junction box (12).

[NOTE: DO NOT CONNECT THE LOW VOLTAGE (24v) ELECTRICAL WIRING (11) COMING FROM THE END JOINER (4) TO ANY LINE VOLTAGE (120-277v) INPUT WIRES FROM JUNCTION BOX]

- Take channel (5) with attached joiner(s) and align it with backplate (18) against the ceiling. Mark hole locations on ceiling for fasteners. (See step # 6 and use required ceiling anchors (10) to support channel (5) onto ceiling). Once channel (5) is in place, tighten the selected fastener to the ceiling until the channel is firmly in place.
- Make sure that the low voltage wire (11) running between end joiner (4) and into floating canopy cover (18) is retained completely between inside the rear of channel (5) and the ceiling.

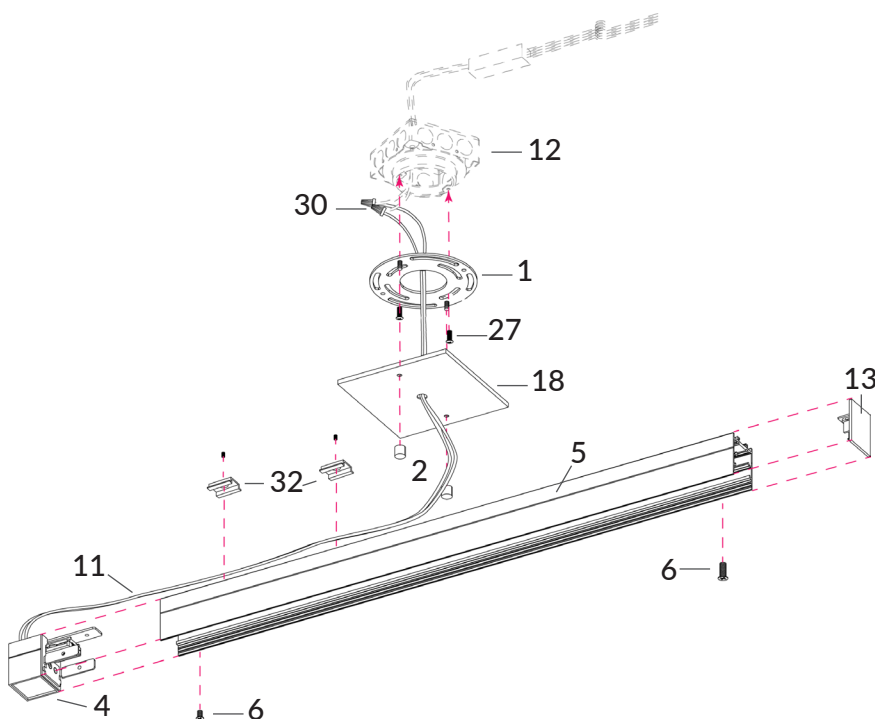

7C. CONNECTING ELECTRICITY FOR INTEGRAL MOUNTED DRIVER WITH FLOATING CANOPY

- a. Place the low voltage electrical wires (23) the 0- 10V dimming wires (31) and the ground wire (33) from the driver (28) into the junction box (12).
- b. Inside the floating canopy backplate (18) Attach the line voltage electrical wires (22) from the junction box to the line voltage wires (21) from the driver (28) using connectors (30).
- c. Optionally, attach the 0-10V dimming wires, (if present in junction box) (12) to 0-10v dimming wires (31) from the driver (28).
- d. Insert mounting brackets (32) in the rear of channel (5) to retain the loose wire between end joiner (4) to floating canopy backplate (18). Also insert one or two mounting brackets (32) as spacers on the other side of the floating canopy to allow the channel (5) to be level once attached to the ceiling (see detail A & B).
- e. Feed the two low voltage wires (11) through the floating canopy (18) and cut the two the wires to the proper length so it will fit with only a small amount of slack when connected inside the floating canopy (18).
- f. Using quick connectors (30) connect the low voltage wire (11) to low voltage wire (23) coming from integral driver (28).

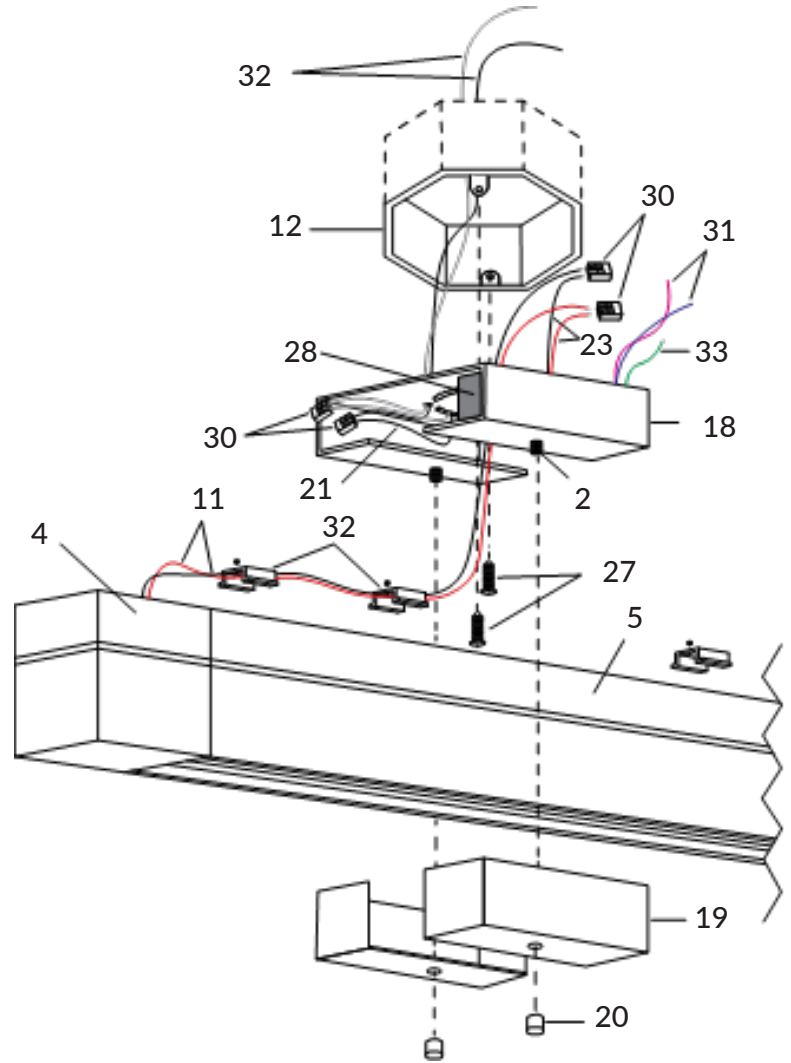

[NOTE: DO NOT CONNECT THE LOW VOLTAGE (24v) ELECTRICAL WIRING (11) COMING FROM THE END JOINER (4) TO ANY LINE VOLTAGE (120-277v) INPUT WIRES FROM THE JUNCTION BOX (12).]

- g. Take channel (5) with attached joiner(s) and align it with backplate (18) against the ceiling, mark hole locations on ceiling for fasteners.(See step # 6 and use required ceiling anchors (10) to support channel (5) onto ceiling). Once channel (5) is in place, tighten the selected fastener to the ceiling until the channel is firmly in place.
- h. Make sure that the low voltage wire (11) running between end joiner (4) and into floating canopy cover (18) is retained completely between inside the rear of channel (5) and the ceiling (see detail A & B).
- i. Align the holes in the canopy covers (19) over the threaded posts on the canopy backplate (18). Then thread and tighten the two decorative finials (20) onto the two threaded posts to secure them together.

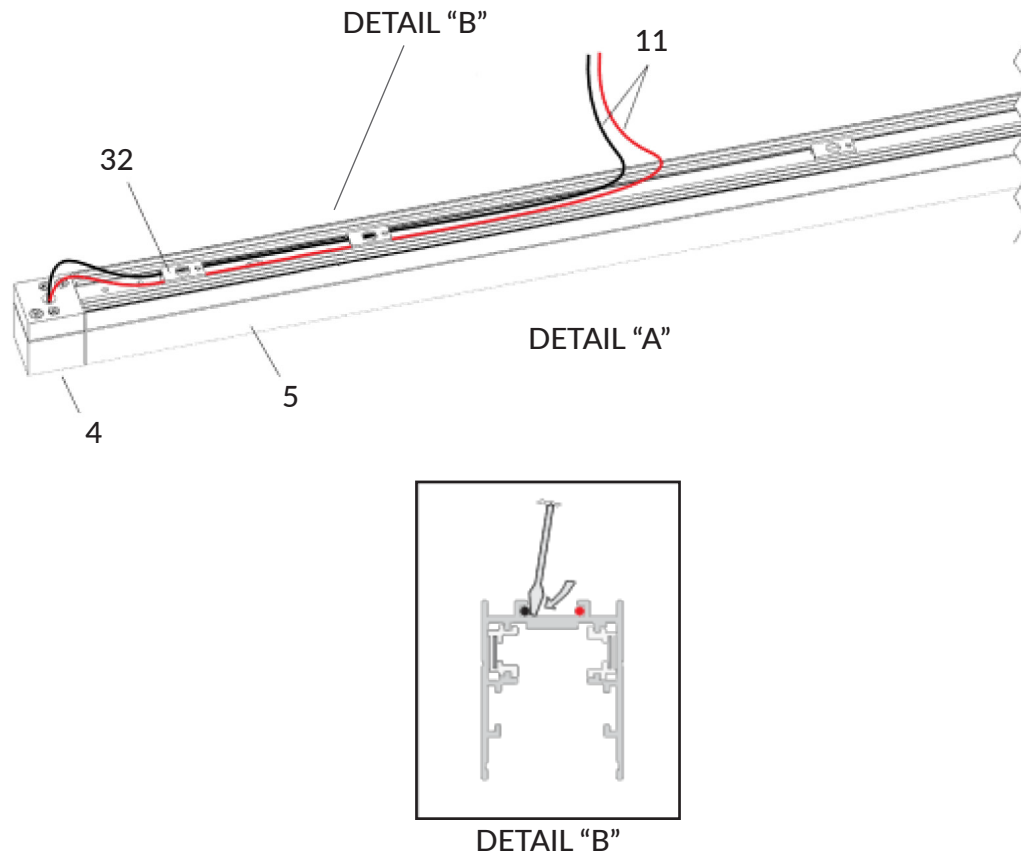

- | | |
|---------------------------------------|--|
| 1. BACKPLATE | 18. FLOATING CANOPY BACKPLATE |
| 2. THREADED STUDS | 19. FLOATING CANOPY FRONT COVER |
| 3. CONNECTOR "A" | 20. DECORATIVE FINIALS |
| 4. END JOINER | 21. LINE VOLTAGE WIRES FROM DRIVER |
| 5. CHANNEL | 22. LINE VOLTAGE WIRES FROM JUNCTION BOX |
| 6. FLAT HEAD SCREW | 23. LOW VOLTAGE WIRES FROM DRIVER |
| 7. JOINER SET SCREWS | 24. END CAP SCREW |
| 8. THREADED HEX NIPPLE | 25. DRIVER |
| 9. JUNCTION BOX COVER PLATE | 26. END CAP SCREW |
| 10. CEILING ANCHOR (by others) | 27. MOUNTING SCREWS |
| 11. LOW VOLTAGE WIRES FROM END JOINER | 28. DRIVER |
| 12. JUNCTION BOX | 29. LOW VOLTAGE WIRES FROM REMOTE DRIVER |
| 13. DECORATIVE END CAP | 30. QUICK CONNECTOR |
| 14. CONNECTOR "B" | 31. 0-10V DIMMING WIRES FROM DRIVER |
| 15. EXTERNAL JOINER | 32. MOUNTING BRACKET |
| 16. INTERNAL JOINER | 33. GROUND WIRE |
| 17. DOUBLE CONNECTOR "C" | |

WALL MOUNTED, REMOTE DRIVER INSTALLATION

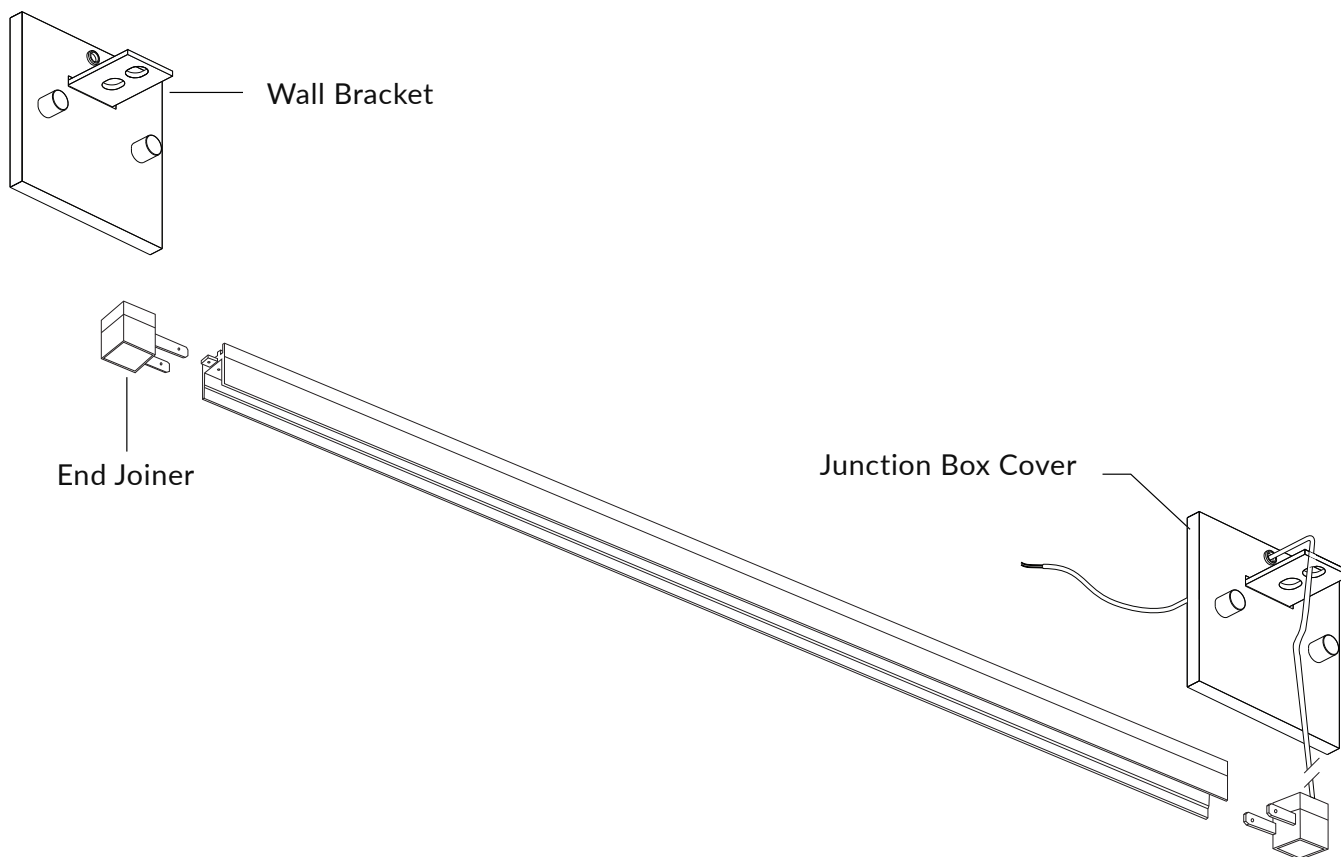

Side Elevation

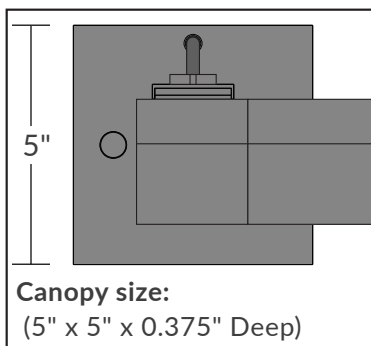

Top View - Side Mount

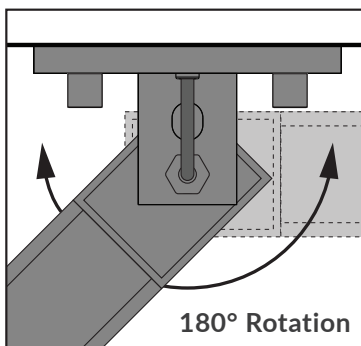

Top View - End Mount

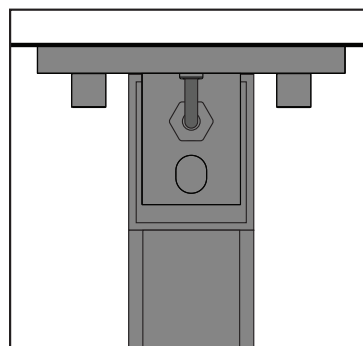

LED MODULE INSTALLATION

1. INSTALL ELECTRICAL CONNECTOR

- Connect channel modular connector (1) to the LED reflector modular connector (2).
- Align the lower brackets (3) [pre-installed in factory] located in the channel (4) with the magnets (5) attached to the pre-cut LED reflector (6).
- Push the powered end of the reflector (6) into the channel (4) first and fully extend the power cable to allow the modular connector (1) to seat straight into the channel (4). Place the non-powered end of the reflector (6) down into the channel (4) until the magnets firmly engage with the brackets.
- Snap the pre-cut diffuser (7) into the grooves of the extruded channel (4) aligned above the reflector (6).

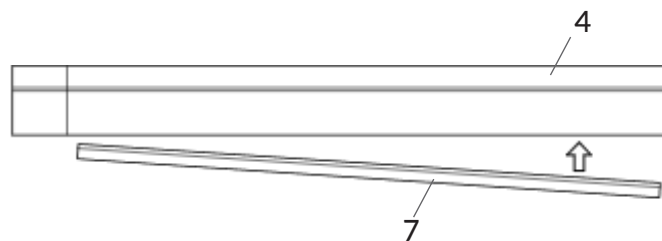
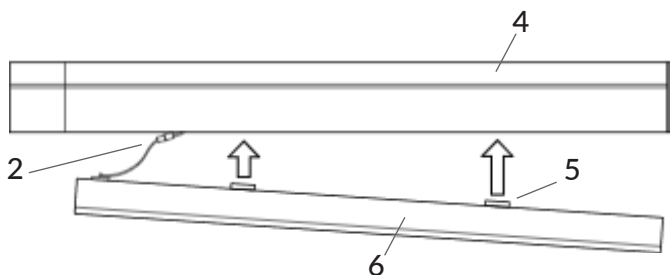
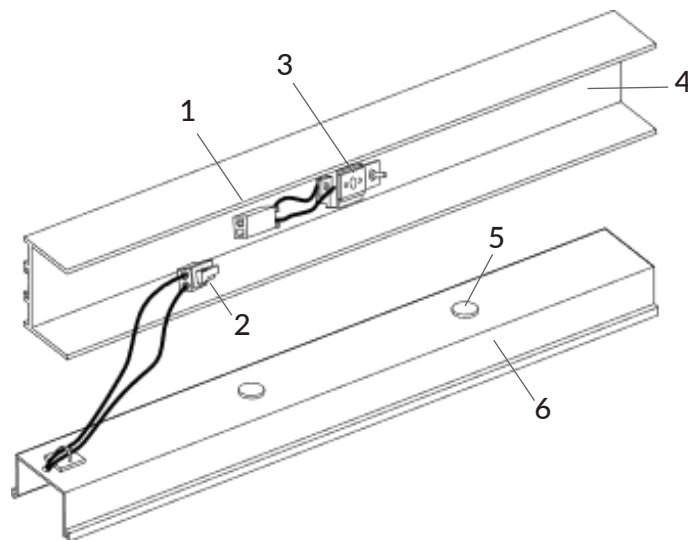

2. CONTINUOUS LED RUN

- Connect channel modular connector (1) to the LED reflector modular connector (2).
- Align the lower brackets (3) [pre-installed in factory] located in the channel (4) with the magnets (5) attached to the pre-cut LED reflector (6).
- Insert the powered end of the first reflector (6) into the first channel (4) and push into place by positioning the magnets (5) over the mounting brackets (3).
- Align the lower brackets (3) [pre-installed in factory] located in the additional channel(s) (4) with the magnets (5) attached to the additional non-powered pre-cut LED reflector(s) (6).
- Insert the powered end of the second reflector (6) into the second channel (4) and push into place by positioning the magnets (5) over the mounting brackets (3). Take care to align the gap filler plastic sections (9) into the end of first channel (6). Repeat this process for each housing and reflector section that needs to be joined with this run of channel.
- Remove the adhesive tape backing from the self-adhesive LED tape (8). Attach the tape to the inside of the reflector (6) starting with the end closest to the power input, and then unrolling the tape away from the power input and firmly adhering it to the adjacent LED reflector(s) (6) that are placed in a continuous row.

- g. Snap the pre-cut diffuser (7) into the grooves of the extruded channel (4). Start inserting the diffuser at the end with the power input and then press the diffuser in place as you move down the extruded channel (4).

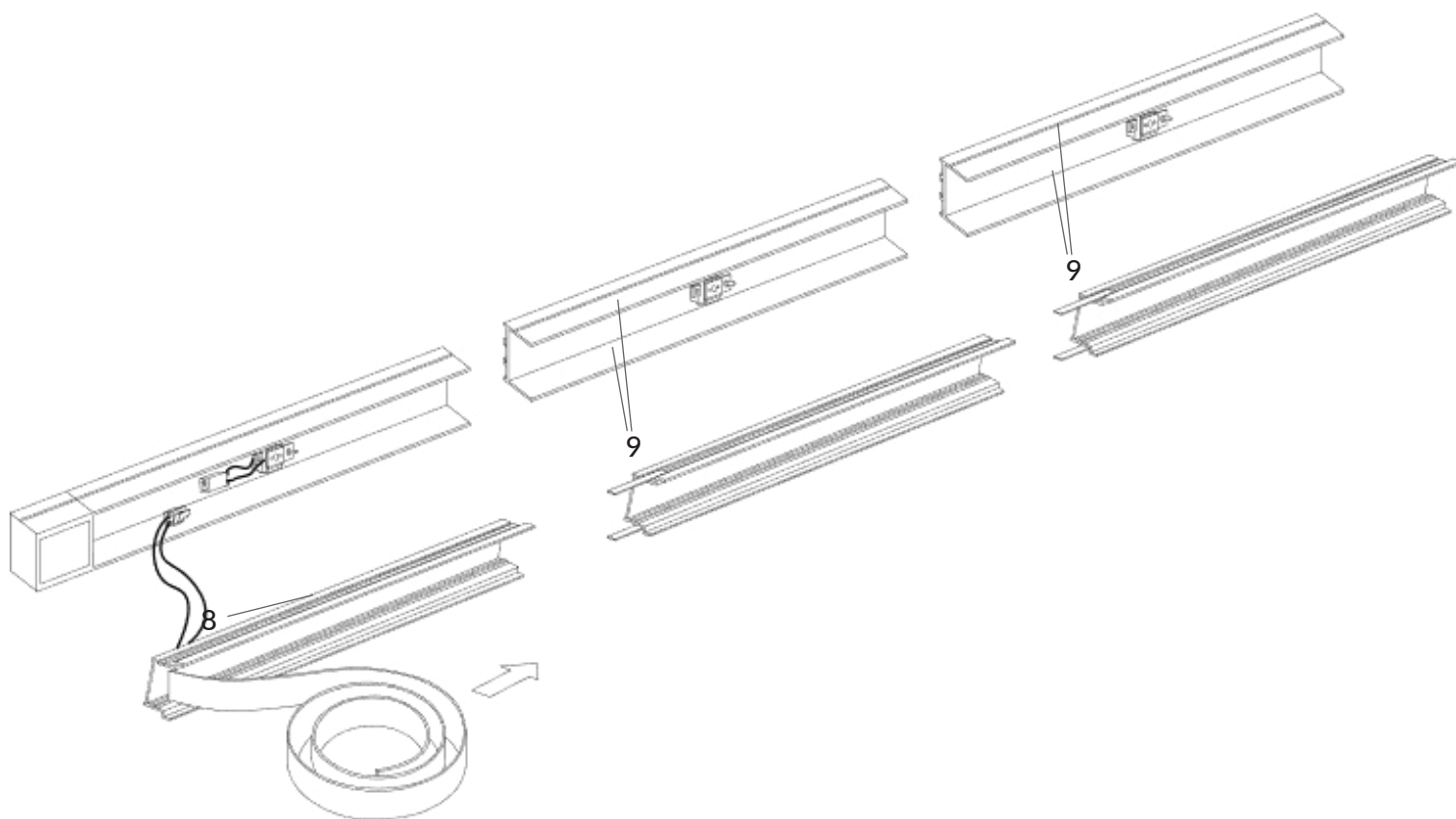
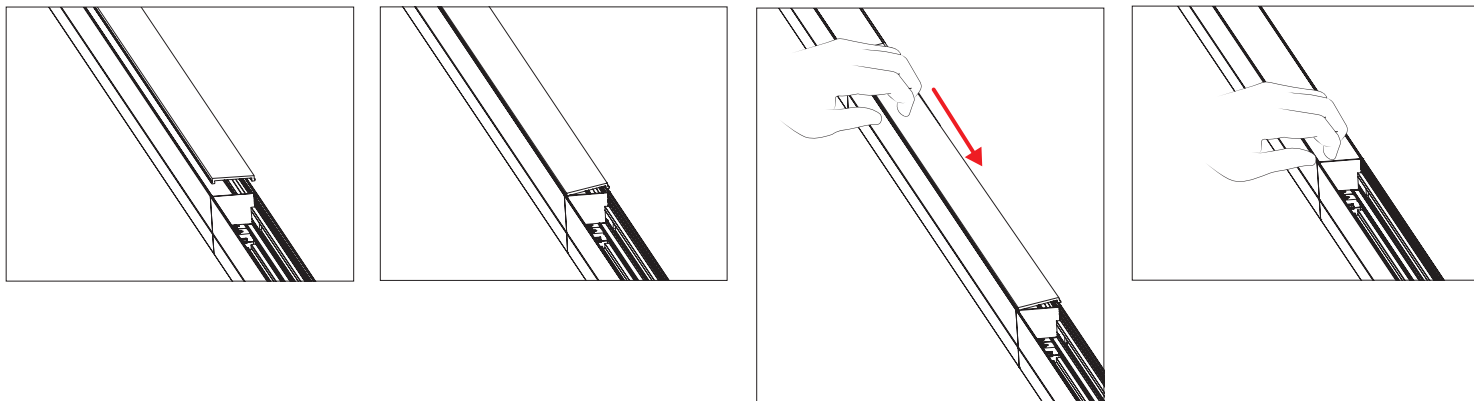

- | | |
|------------------------------|----------------------------|
| 1. CHANNEL MODULAR CONNECTOR | 6. PRE-CUT LED REFLECTOR |
| 2. MODULAR CONNECTOR | 7. PRE-CUT DIFFUSER |
| 3. LOWER BRACKETS | 8. SELF-ADHESIVE LED TAPE |
| 4. CHANNEL | 9. FILLER PLASTIC SECTIONS |
| 5. MAGNETS | |



CAUTION

Turn off the main power at the circuit breaker before installing the fixture in order to prevent possible shock. If you are unfamiliar with proper electrical wiring connections, obtain the services of a qualified electrician.

GENERAL

Read all instructions carefully for safe operation and installation. All electrical connections must be in accordance with local and national electrical code (N.E.C.) standards. Remove the fixture and mounting package from the box. Make sure no parts are missing by referencing the illustrations on these Installation Instructions. Please contact Blackjack Lighting at 847-941-0588 if any parts are missing or damaged. This product is suitable for DAMP locations.

INSTALLATION OF SPOT LIGHT INTO JACKTRACK

1. Position pendant adapter in desired location along track.

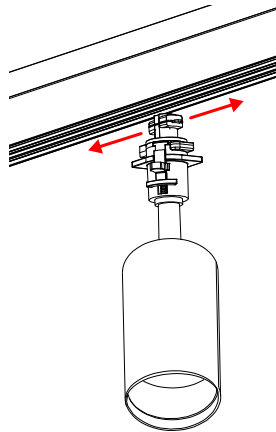

2. Push track adapter into channel with copper prongs aligned with channel track.

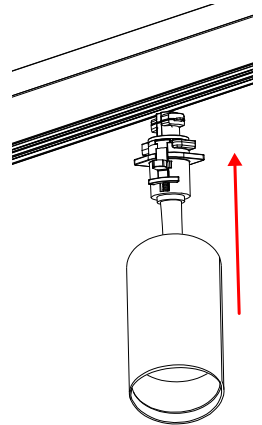

3. Push up so that the spring lever is compressed and turn counter clock-wise 90 degrees. *NOTE: If it locks up when turning take adapter out and try it with adapter facing the other direction.*

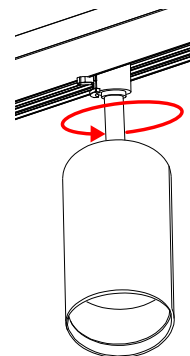
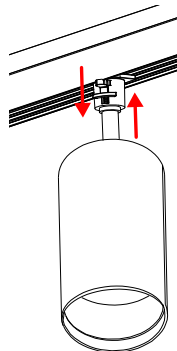

4. Turn until spring lever falls into track and adapter "clicks" into place. This secures the adapter.

NOTE: Adapter may be removed and repositioned as needed along track.

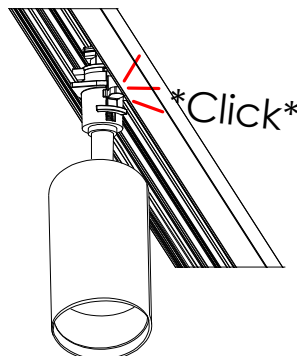

Scan this QR code to view Blackjack's animated JackTrack Adapter Installation Instructions.

REPLACING SPOT LIGHT OPTICAL LENS

1. Hold spot light with front edge facing down.
2. Unscrew trim ring (7) on front edge of spot light and remove optical lens (6) from trim ring. Retain hex louver (9) or spacer ring (8) that sits inside trim ring (7).
3. Make sure that a spacer ring (8) or a hex louver (9) is sitting in the trim ring (7) before adding the optical lens (6). Hold spot light front edge downward. Carefully screw trim ring (7) back into front edge of spot light housing (2).

ADDING HEX LOUVER TO SPOT LIGHT OPTICAL LENS

4. Repeat steps #1 and #2, above.
5. Remove spacer ring (8) from inside of trim ring (7).
6. Place hex louver (9) inside of trim ring (7). Place spot light optic (6) up against hex louver (9).
7. Turn spot light with front edge facing downward. Repeat Step 3 (above).

REPLACING COB LED LIGHT SOURCE

1. Repeat steps #1 and #2, above.
2. Unscrew COB hold down collar (4).
3. Remove COB LED light source (3).
4. Clean thermal paste or silicone heat pad behind old COB LED light source (3).
5. Apply new heat pad or thermal paste behind COB LED light source (3).
6. Re-insert the two mounting screws (5) into the COB hold down collar (4).
7. Re-insert optical lens (6) with spacer ring (8) [or hex louver (9)] into trim ring (7) and follow instructions above to re-attach trim ring (7) to spot light housing (2).

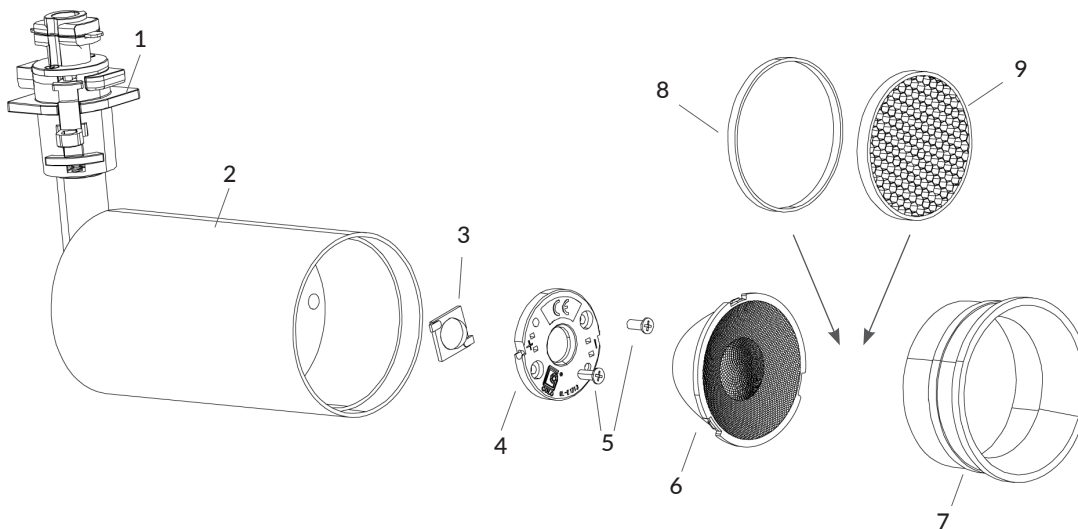

1. JACKTRACK ADAPTER
2. CYLINDRICAL HOUSING
3. COB LED LIGHT SOURCE
4. COB LED HOLD-DOWN COLLAR
5. MOUNTING SCREWS
6. OPTICAL LENS
7. TRIM RING
8. OPTIONAL SPACER RING
(Use when Hex Louver is not installed)
9. OPTIONAL HEX LOUVER
(Remove Spacer Ring to install in front of Optical Lens)

TO ATTACH TRACK ADAPTER



Scan this QR code to view BlackJack's animated JackTrack Adapter Installation Instructions.

1. Position pendant adapter in desired location along track.

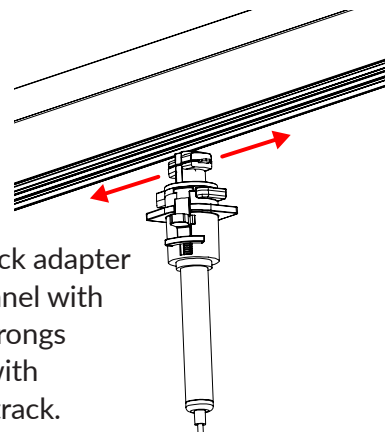

2. Push track adapter into channel with copper prongs aligned with channel track.

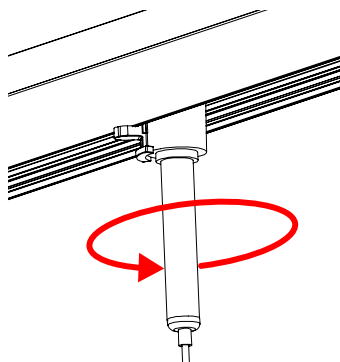
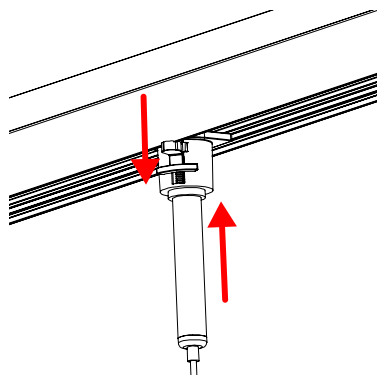

3. Push up so that the spring lever is compressed and turn counter clock-wise 90 degrees. *Note: If it locks up when turning take adapter out and try it with adapter facing the other direction.*

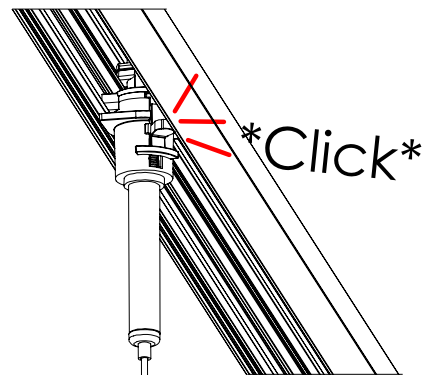

4. Turn until spring lever falls into track and adapter "clicks" into place. This secures the adapter.

NOTE: Adapter may be removed and repositioned as needed along track.

TO REMOVE TRACK ADAPTER

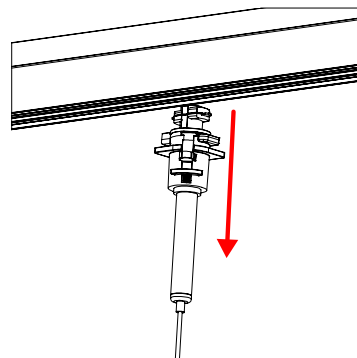
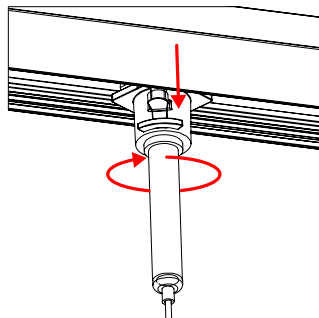
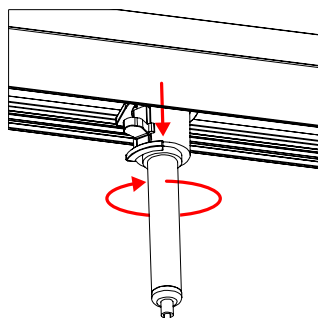

1. Pull spring lever down so it clears the track and rotate adapter clockwise 90 degrees.

2. Gently pull down to remove adapter.

CAUTION

Turn off the main power at the circuit breaker before installing the fixture in order to prevent possible shock. If you are unfamiliar with proper electrical wiring connections, obtain the services of a qualified electrician.

GENERAL

Read all instructions carefully for safe operation and installation.

All electrical connections must be in accordance with local and national electrical code (N.E.C.) standards.

Remove the fixture and mounting package from the box. Make sure no parts are missing by referencing the illustrations on these Installation Instructions. Please contact Blackjack Lighting at 847-941-0588 if any parts are missing or damaged. This product is suitable for DAMP locations.

JACKTRACK PENDANT ADAPTER EXPLODED VIEW

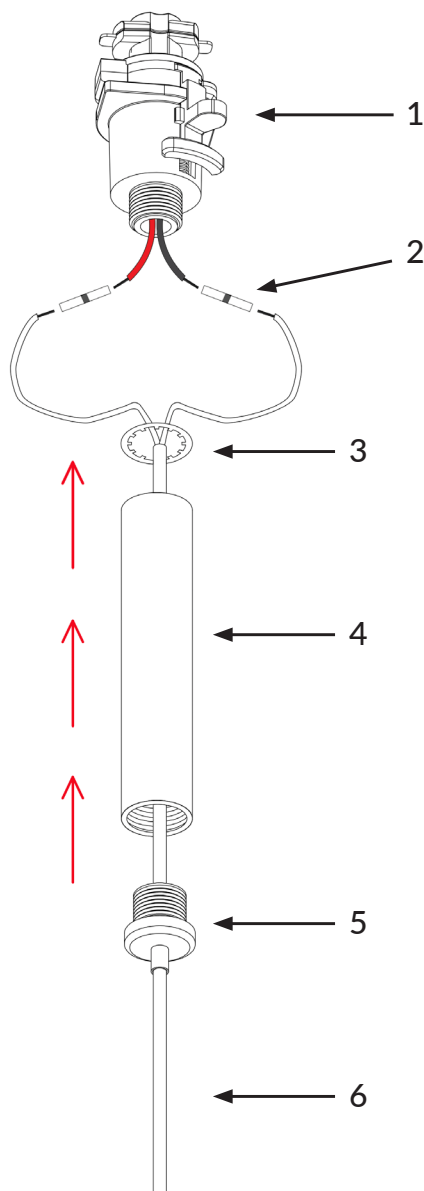

1. SPRING-LOADED LEVER
2. SOLDER STICKS
3. TOOTHED WASHER
4. STEM BODY
5. ADJUSTABLE CABLE GRIPPER
6. CABLE

PARTS BAG INCLUDES:

- THESE INSTRUCTIONS
- TWO (2) SOLDER STICK WIRE CONNECTORS
- ONE (1) PIECE BLACK HEAT SHRINK TUBING

1. DETERMINE REQUIRED CABLE LENGTH

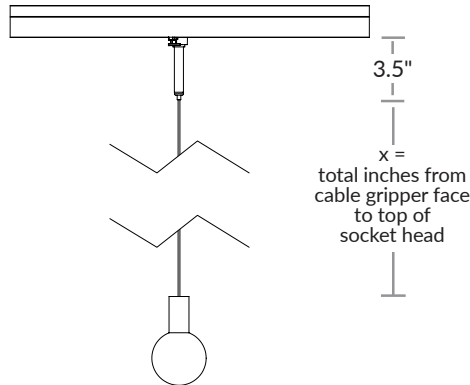

A. Determine overall length of cable from the cable gripper face to top of socket head (x"). Measure and place gripper in this position.

NOTE: Cable gripper face sits 3.5" below bottom of channel track.

2. CUT AND STRIP CABLE END

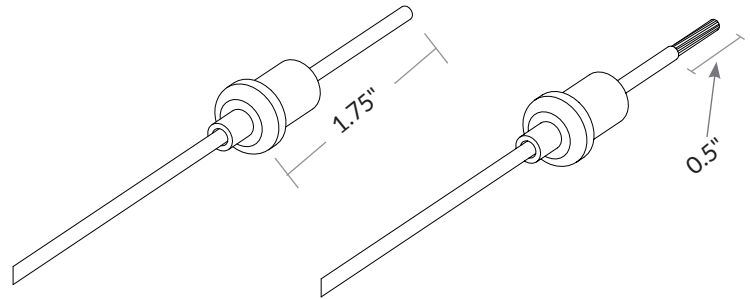

A. Cut cable end 1.75" above face of gripper.

B. Strip off outer insulation 0.5" from end.

NOTE: Cable cannot be adjusted after cutting.

3. INSERT CABLE INTO TRACK ADAPTER



A. Unscrew stem from adapter.

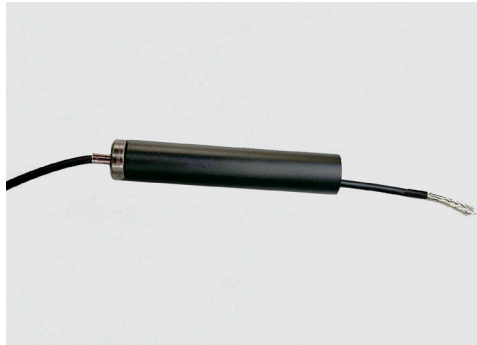

B1. Pull cable end out from gripper and thread gripper into stem.

B2. Re-attach gripper to stem.



C1. Twist exposed braided wire into a bundle.

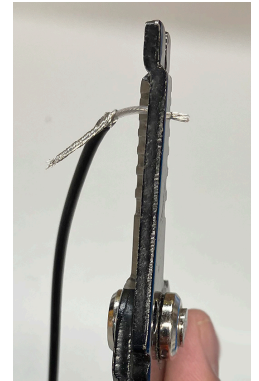

C2. Strip off inner insulation (approx. 3/4").



D1. Replace toothed washer on cable.

D2. Insert heat shrink tube onto cable to be used in Step K.

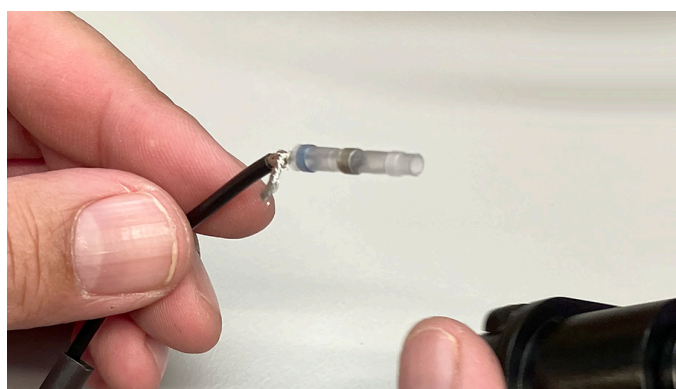

E. Insert middle stripped wire into solder stick. Make sure exposed wire is inside center solder ring.

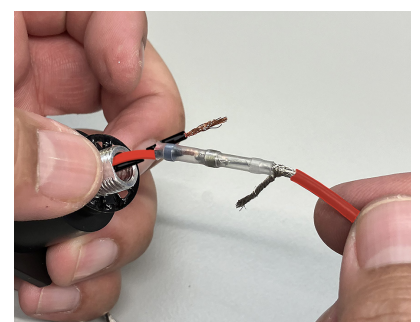

F. Insert red cable from track adapter into solder stick. Make sure exposed wire is inside center solder ring.



G. Heat up solder stick with heat gun. Temperature must reach at least 285°F to thoroughly melt solder ring.

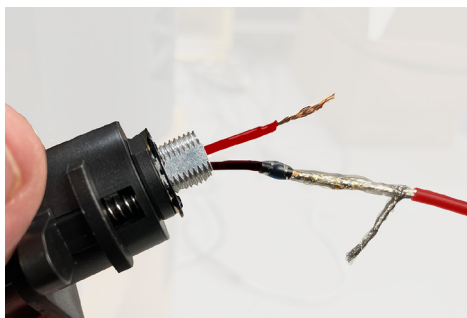

H. Soldering is successful when the solder ring melts and evenly coats the exposed wire ends.

EXAMPLE:

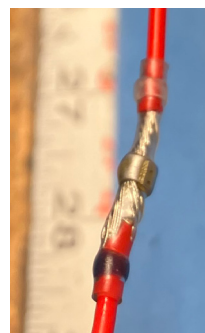

**NOT MELTED
PROPERLY**



**MELTED
PROPERLY**

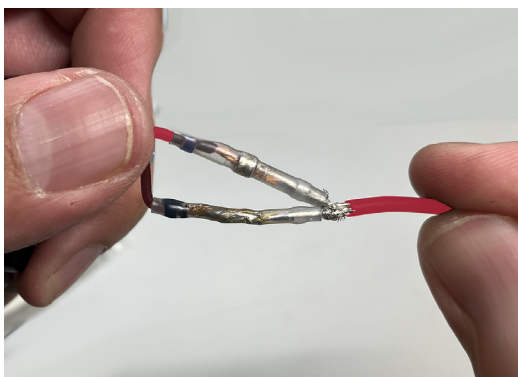

I. Insert black cable from track adapter into second solder stick. Insert twisted braided wire bundle from cable into the other side.



J. Repeat Steps G & H.

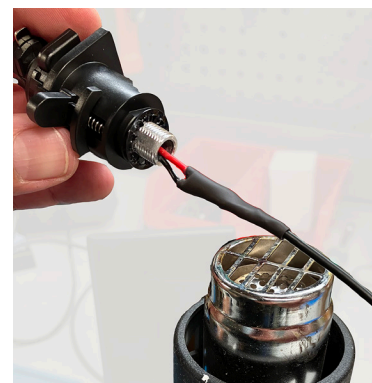

K. Place black heat shrink tubing over both solder sticks and shrink with heat gun.



L. Depress collar on gripper and adjust cable through gripper to desired cable length (see Step 1).



M. Screw the stem (with toothed washer) back over threaded end of track adapter.



N. Attach pendant adapter to track to test wire connection.

