

LWA PENDANT

LWA-022P-XX-27U-30K

**IMPORTANT**

- For factory pre-set option, customer to select pattern and provide distance of longest pendant. Signoff on Blackjack-generated configuration drawing or designer-supplied submittal drawing required. Pendants are pre-installed and pre-configured by Blackjack per signed submittal drawing. Customized installation instructions are supplied as necessary.
- For customer-set (DIY) option, pendants are installed in canopies with approximately 6' cable exposed. Customer to connect canopies and make adjustments to cable length in-field as desired.
- Standard 8' total of field-adjustable cable is included with each pendant (unless otherwise specified); no cutting or splicing required should adjustments need to be made in the field.
- Appropriate number of joiners and spacers included to complete configuration installation.
- Individual canopies with pendants can weigh as much as 50 pounds. Canopies and system must be mounted to rigid ceiling material (e.g., sheet rock, fire-rated plywood or similar) that can support system weight and accept drywall anchors, expandable fasteners or similar structural fasteners.

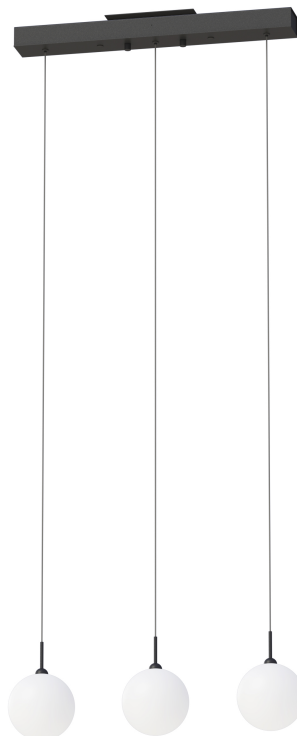

LWA PENDANT

LWA-022P-XX-27U-30K

CAUTION

TURN OFF THE MAIN POWER AT THE CIRCUIT BREAKER BEFORE INSTALLING THE FIXTURE IN ORDER TO PREVENT POSSIBLE SHOCK

IF YOU ARE UNFAMILIAR WITH PROPER ELECTRICAL WIRING CONNECTIONS OBTAIN THE SERVICES OF A QUALIFIED ELECTRICIAN

GENERAL

- Read all instructions carefully for safe operation and installation.
- All electrical connections must be in accordance with local and national electrical code (N.E.C) standards.
- Remove the fixture and any additional package from the box and make sure that no parts are missing by referencing the illustrations on the installation instructions. Please contact Blackjack Lighting if any parts are missing or damaged.
- This product is suitable for damp locations.

INSTALLATION

1- PREPARATION

- Remove the fixture from its box. Unpack the bundled wire packages, be careful not to bend or kink wires when unpacking. Remove additional packaging for light guides (2).
- Remove the channel (5) from the fixture pan (3) by loosening the two decorative finials (4).

2- SURFACE MOUNTING - (Remote/ Canopy Mounted Driver)

- A 47" or 23" length of channel (5) will require at least two fasteners to mount surface mount the first canopy to a ceiling. A 47" length of channel will require two fasteners for each additional channel connected in a row, and a 23" length of channel will require a minimum of one fastener when used as an additional channel in a row.

b. Center Feed Surface Mounting:

Mount Ceiling Plate (6) onto Junction box (1). Mount Ceiling plate (6) to Channel (5) by inserting the two threaded mounting studs (7) into the rear of Channel (5) and tighten it firmly from the inside.

c. End Feed Surface Mounting:

-Mount Ceiling Plate (6) onto Junction box (1).
 -Attach joiner bracket (21) to the two threaded studs that are at the end of Channel (5)
 -While the channel (5) is being mounted to the ceiling, make sure to attach the joiner bracket (21) to the two studs that are coming from Mounting Plate (6).

3A- ADD EXTERNAL JOINER AT END OF CHANNEL

- For connection to additional channel sections with an external joiner (11) either ("L"/ "I"/ "T"/ "X" Joiner).
- Insert side support brackets (12) into the inner sides of the channel (5). Push the straight and the right-angle support brackets (12) into the channel (5) as far as it will go.
- Insert side support brackets (12) into the inner sides of the additional channel(s) (10) on the other side of the external joiner (11). Push the straight and the right-angle support brackets (12) into the channel(s) (10) as far as they will go.

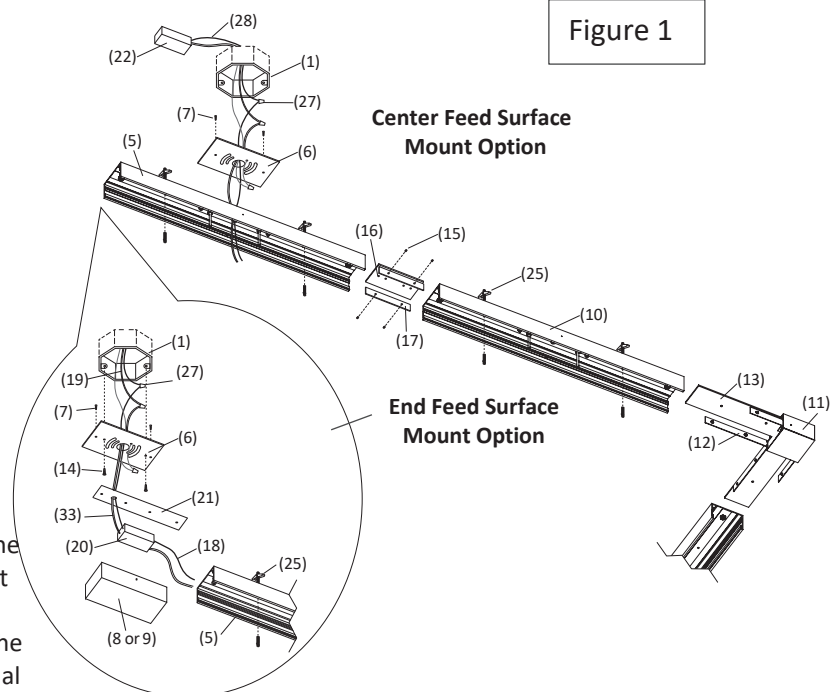

Figure 1

- d. Attach back support bracket (13) of the selected external joiner (11) onto the two threaded studs at the end of the first channel (5) and the additional channels(s) (10). Install two nuts on each end of support bracket (13) and tighten down.
- e. Slide back the straight support bracket (12) into the external joiner (11) until the support bracket (12) is spaced half way into the channel (5) with the other portion inside the joiner (11)
- f. Lock both side support brackets in place in the channel(s) by tightening set screw (15). Tighten the set screws (15) inside the selected external joiner (11) so it meets tightly with the end of channel(s).

3B- ADD INTERNAL JOINER AT END OF CHANNEL

- a. For connection to additional channel sections (10) with an internal joiner (16)
- b. Attach one end of internal joiner (16) onto the two threaded studs at the end of the channel (5). Install two nuts and tighten.
- c. Insert side support brackets (17) into the inner sides of the first channel (5). Push them all the way into the channel (5)
- d. Mount the internal joiner (16) onto the two threaded studs on the additional channel (10). Install two nuts and tighten.
- e. Slide back the side support bracket (17) until they are spaced half way into the channel (5) with the other portion inside the additional channel (10). Tighten the remaining set screws (15) until fully tight

4A. CONNECT ELECTRICITY (End Feed)

- a. Attach the low voltage fixture wires (26) coming from the back of channel (5) to the low voltage wire (18) coming from integrally mounted driver (20) in end feed (8 or 9) and splice the wires together in the end feed using quick connector (27).
- b. Connect the Line voltage input wire coming from the driver (33) to the Line voltage Input (19) from the junction box (1)
- c. Attach End feed cover (8 or 9) over the end feed backplate (21) and secure with supplied screws.

4B. CONNECT ELECTRICITY (Center Feed)

- a. Attach Low voltage fixture wires (26) coming from the back of channel (5) to the low voltage wires coming through the junction box (1) from remote mounted driver (22). Splice the wires using supplied wire connectors (27).

[NOTE: DO NOT CONNECT THE LOW VOLTAGE (24v) ELECTRICAL WIRING (26) COMING FROM THE CHANNEL (5) TO A LINE VOLTAGE (120-277v) INPUT FROM THE JUNCTION BOX (1)]

Figure 2

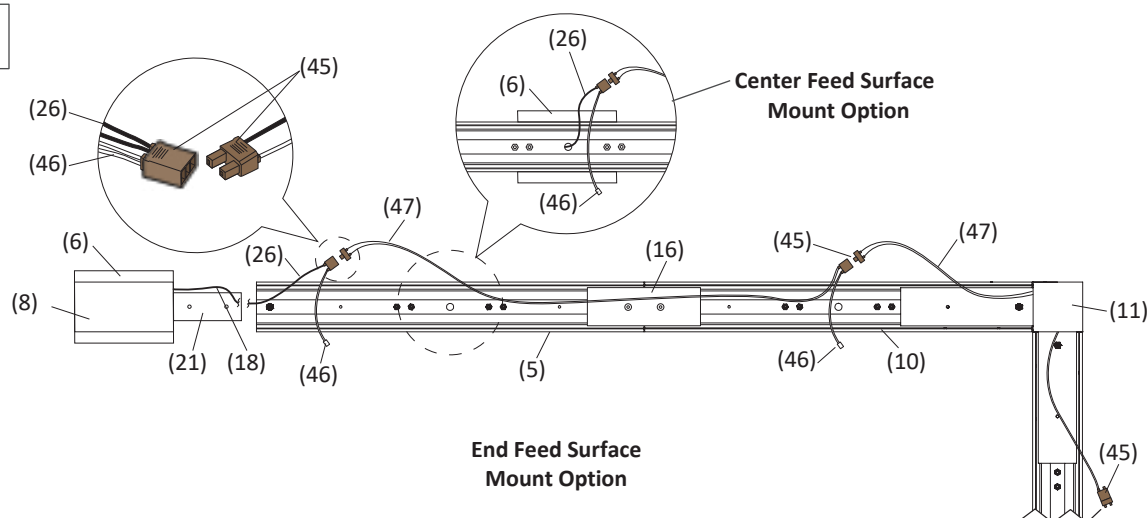

5. CONNECT THE INTERNAL CHANNEL WIRING CONNECTIONS

The low voltage wiring (26) coming from the back of the channel (5) is attached to the female side of the brown low voltage connectors (45). Also attached is the wire harness with the white quick disconnects (46) used to transfer power to the pendant wire assembly. The male side of the brown connectors is located inside the channel (5) of the fixture and is attached to the 48" jumper wires (47) which carry low voltage power from one fixture to the next. Tighten the zip tie restraint on the jumper cable and attach to the brown connectors in the next channel. Once all the low voltage connections are made you can then suspend the fixture pan (3) from the internal suspension wires (hook and loop) (32) (located inside the fixture).

6. DETERMINE THE APPROPRIATE LENGTH OF EACH PENDANT

(if pendant is pre-configured; pendants will only require minor adjustments). Push the excess wire up into the canopy by pressing the small barrel of the gripper (23) upward. This will release the wire tension and allow the suspended wire to be pulled through gripper. Roll excess wire into a small loop inside the canopy. Wrap the supplied Velcro strap around this loop to keep the excess wire from falling outside the fixture pan (3).

7. CONNECT THE CANOPY COVER TO THE BACKPLATE

Make sure all wires are carefully placed inside fixture pan (3). Secure the fixture pan (3) to the channel (5) by tightening the two decorative finials (4).

8. FINE TUNE CABLES

- a. Once the canopy is in place, fine tune the wire lengths longer or shorter to get each pendant adjusted to its preferred length by adjusting the gripper (23). For pendants that are prearranged by Blackjack; minor adjustments may be required. Each pendant has a screw in light guide (2) (shipped separately). Gently screw into place.
- b. Once the length of each wire has been established, any remaining bends or kinks in the wire can be straightened by bending out the kinks by hand while heating the cord up with the warm air from a hair dryer or heat gun. A handheld wire straightening kit can be provided by Blackjack (reference instructions provided with kit).

Figure 3

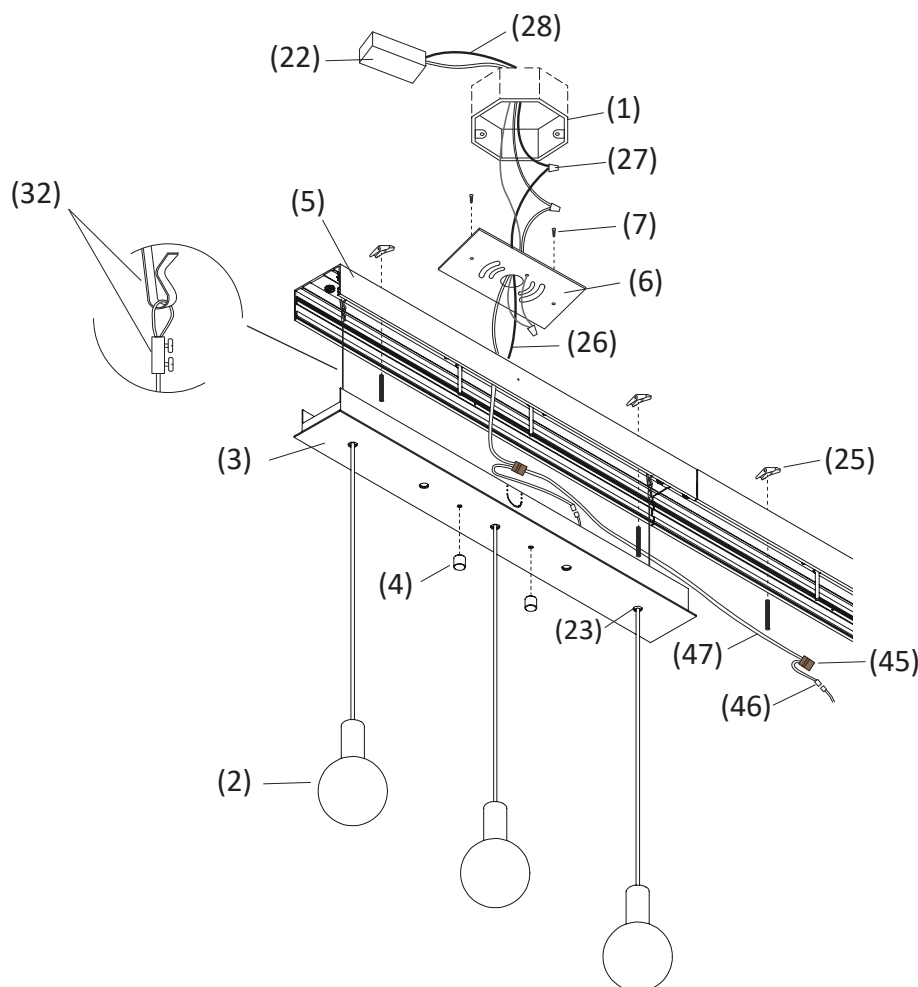

Surface Mount End Feed

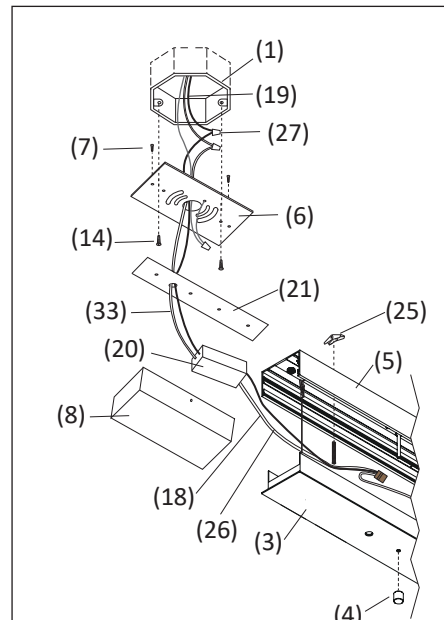

Surface Mount Long End Feed

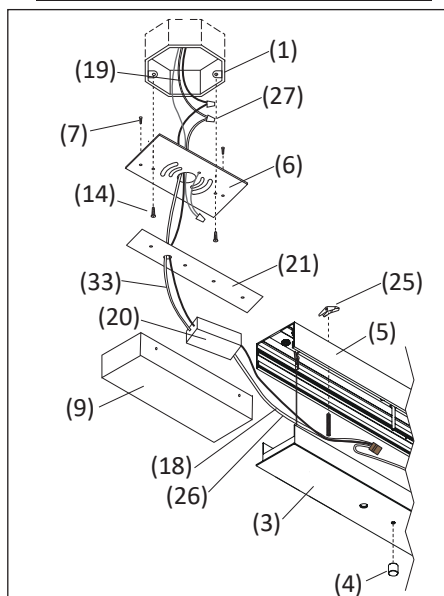

- | | | |
|---------------------------------|------------------------------------------------|---------------------------------------------------|
| 1. JUNCTION BOX (by others) | 12. EXTERNAL JOINER SIDE SUPPORT BRACKET | 23. PENDANT GRIPPER |
| 2. LIGHT GUIDES | 13. EXTERNAL JOINER BACK SUPPORT BRACKET | 25. CEILING ANCHOR (by others) |
| 3. FIXTURE PAN | 14. MOUNTING SCREWS | 26. 24V LOW VOLTAGE FIXTURE WIRES FROM CHANNEL |
| 4. DECORATIVE FINIALS | 15. SUPPORT BRACKET SET SCREW | 27. WIRE CONNECTOR |
| 5. CHANNEL | 16. INTERNAL JOINER | 28. 24V LOW VOLTAGE WIRES FROM REMOTE DRIVER |
| 6. CEILING PLATE | 17. INTERNAL JOINER SIDE SUPPORT BRACKET | 32. INTERNAL SUSPENSION WIRES/LOOP & HOOK |
| 7. CEILING PLATE SCREWS | 18. 24V LOW VOLTAGE WIRES FROM INTEGRAL DRIVER | 33. LINE VOLTAGE INPUT WIRES FROM INTEGRAL DRIVER |
| 8. END DRIVER FEED HOUSING | 19. LINE VOLTAGE SUPPLY WIRES FROM J-BOX | 45. BROWN LOW VOLTAGE CONNECTORS |
| 9. LONG END DRIVER FEED HOUSING | 20. INTEGRAL DRIVER | 46. WHITE QUICK DISCONNECT |
| 10. ADDITIONAL CHANNEL SECTIONS | 21. JOINER BRACKET | 47. 24V LOW VOLTAGE JUMPER WIRES |
| 11. EXTERNAL JOINER | 22. REMOTE DRIVER | |