

MILO 24" VANITY



SPECIFICATIONS

Finish	Satin Nickel (Standard)
Special Order Finishes	Matte Black, Brushed Brass, Bronze, and Satin Gold
LED Color Temperature	3000K (standard) 2700K, 3500K, or 4000K also available
Fixture Wattage	21 Watts
Delivered Lumens	1280 Lm (measured at 3000K)
Dimming	TRIAC Dimming (Standard) Universal (TRIAC, ELV, 0-10V) (Special Order)
Color Rendering Index	90CRI
Input Voltage	120VAC - 50/60Hz
Pendant Dimensions	21"L x 5"W x 4"D

CUSTOM OPTIONS

See page 2 for finish and backplate options.

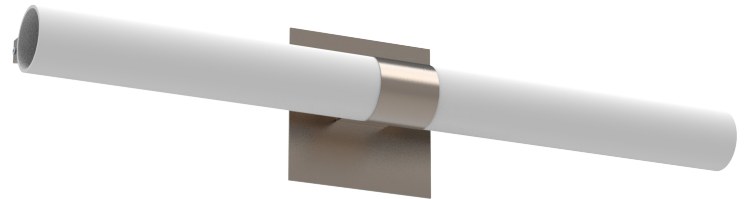
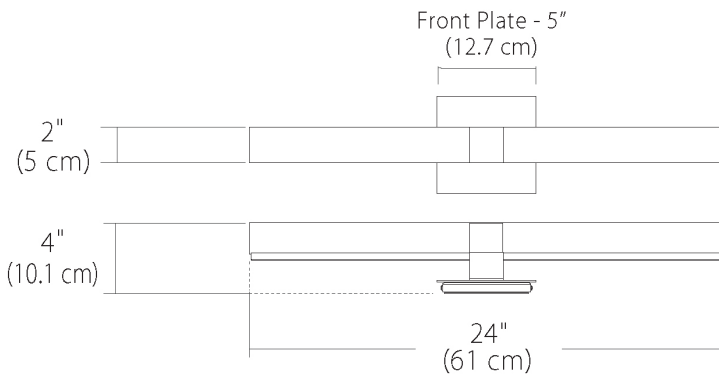

(Shown in Satin Nickel)



ORDERING GUIDE

SERIES	SIZE	FINISH	VOLTS / DIMMING	CCT	OUTPUT	BACKPLATE
MLO	24V				SO	
MLO Milo	24V 24" Vanity	Standard SN - Satin Nickel Special Order BB - Brushed Brass BL - Matte Black BZ - Bronze SG - Satin Gold	Standard 12T 120VAC TRIAC Dimming Special Order 27U - 12-277VAC (0-10V Dimming)	27K - 2700K 30K - 3000K 35K - 3500K 40K - 4000K (30K Standard)	SO Standard Output	S4 - 4.6" Shallow Backplate (Standard) (Driver located inside J-Box) DB - Deep Backplate (Special Order) (Driver located inside Backplate)

Example Part Number: MLO - 24V - SN - 12T - 30K - SO - S4

Socket Color

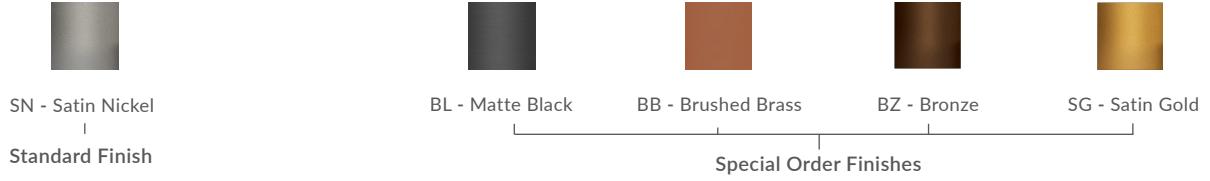

Volts / Dimming

12T: Input: 120V . Dimming: TRIAC (Standard)
27U: Input: 120-277V . Dimming: TRIAC/ ELV/ 0-10V (Deep Backplate Only) (Special Order)

Color Temperature

27K: 2700K
30K: 3000K (Standard)
35K: 3500K
40K: 4000K

Backplates

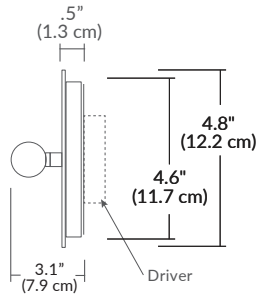

Standard Backplate

S4 - 4.6" Shallow Backplate (4.6" H, 4.6" W, .5" D) - Driver located inside junction box

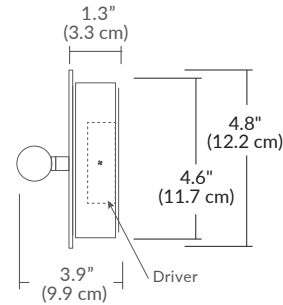

Special Order Backplate

DB - Deep Backplate (4.6" H, 4.6" W, 1.3" D) - Driver located inside backplate